

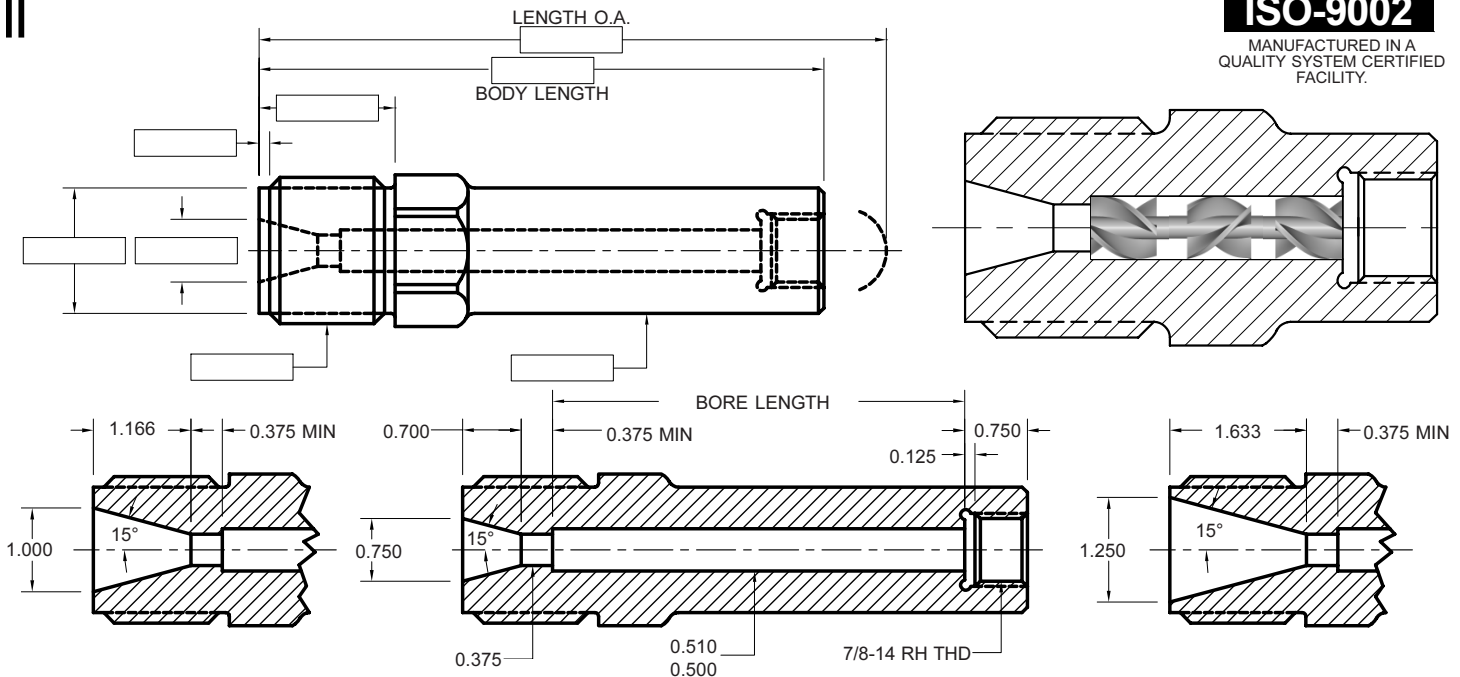

COLOR MIXING NOZZLE Order Guide

FOR HELIX MIXER SEGMENTS

ISO-9002
 MANUFACTURED IN A
 QUALITY SYSTEM CERTIFIED
 FACILITY.



BODY LENGTH	REAR OPENING	BORE LENGTH	# OF SEGMENTS
4.250	0.750 (19.05mm)	2.025/2.030	3 (2 END, 1 MIDDLE)
	1.000 (25.4mm)	NA	NA
	1.250 (31.75mm)	NA	NA
5.250	0.750 (19.05mm)	2.775/2.780	4 (2 END, 2 MIDDLE)
	1.000 (25.4mm)	2.775/2.780	4 (2 END, 2 MIDDLE)
	1.250 (31.75mm)	2.025/2.030	3 (2 END, 1 MIDDLE)
6.250	0.750 (19.05mm)	4.275/4.280	6 (2 END, 4 MIDDLE)
	1.000 (25.4mm)	3.525/3.530	5 (2 END, 3 MIDDLE)
	1.250 (31.75mm)	2.775/2.780	4 (2 END, 2 MIDDLE)
7.250	0.750 (19.05mm)	5.025/5.030	7 (2 END, 5 MIDDLE)
	1.000 (25.4mm)	4.275/4.280	6 (2 END, 4 MIDDLE)
	1.250 (31.75mm)	4.275/4.280	6 (2 END, 4 MIDDLE)
8.250	0.750 (19.05mm)	5.775/5.780	8 (2 END, 6 MIDDLE)
	1.000 (25.4mm)	5.775/5.780	8 (2 END, 6 MIDDLE)
	1.250 (31.75mm)	5.025/5.030	7 (2 END, 5 MIDDLE)
9.250	0.750 (19.05mm)	7.275/7.280	10 (2 END, 8 MIDDLE)
	1.000 (25.4mm)	6.525/6.530	9 (2 END, 7 MIDDLE)
	1.250 (31.75mm)	5.775/5.780	8 (2 END, 6 MIDDLE)
10.250	0.750 (19.05mm)	8.025/8.030	11 (2 END, 9 MIDDLE)
	1.000 (25.4mm)	7.275/7.280	10 (2 END, 8 MIDDLE)
	1.250 (31.75mm)	7.275/7.280	10 (2 END, 8 MIDDLE)
11.250	0.750 (19.05mm)	8.775/8.780	12 (2 END, 10 MIDDLE)
	1.000 (25.4mm)	8.775/8.780	12 (2 END, 10 MIDDLE)
	1.250 (31.75mm)	8.025/8.030	11 (2 END, 9 MIDDLE)
12.250	0.750 (19.05mm)	10.275/10.280	14 (2 END, 12 MIDDLE)
	1.000 (25.4mm)	9.525/9.530	13 (2 END, 11 MIDDLE)
	1.250 (31.75mm)	8.775/8.780	12 (2 END, 10 MIDDLE)
13.250	0.750 (19.05mm)	11.025/11.030	15 (2 END, 13 MIDDLE)
	1.000 (25.4mm)	10.275/10.280	14 (2 END, 12 MIDDLE)
	1.250 (31.75mm)	10.275/10.280	14 (2 END, 12 MIDDLE)
14.250	0.750 (19.05mm)	11.775/11.780	16 (2 END, 14 MIDDLE)
	1.000 (25.4mm)	11.775/11.780	16 (2 END, 14 MIDDLE)
	1.250 (31.75mm)	11.025/11.030	15 (2 END, 13 MIDDLE)
15.250	0.750 (19.05mm)	13.275/13.280	18 (2 END, 16 MIDDLE)
	1.000 (25.4mm)	12.525/12.530	17 (2 END, 15 MIDDLE)
	1.250 (31.75mm)	11.775/11.780	16 (2 END, 14 MIDDLE)



PLASTIC PROCESS EQUIPMENT, INC.

EAST 8303 CORPORATE PARK DRIVE
 MACEDONIA, OHIO 44056-2300
 216-367-7000 • FAX: 216-367-7022
 TOLL FREE: 800-321-0562

WEST 6385 MONTESSOURI STREET
 LAS VEGAS, NEVADA 89113-1186
 702-433-6385 • FAX: 702-433-6388
 TOLL FREE: 800-258-8877

www.ppe.com
 e-mail: sales@ppe.com

Toll Free: USA, Canada & Mexico
800-362-0706

Order Fax: 800-223-8305