



SPRAY CAN AND TOOL HOLDER COMBO

THE BETTER CAN-TOOL HOLDER!

Two mounting holes on back



- €Mount on machine or tool cart with screws or magnets.
- €Safely holds cans away from heat.
- €Holds 12,16 & 20 ounce cans.
- €Powder coated steel.
- €Keeps tools and sprays handy - not on top of your machine and not on the floor.
- €Dimensions: 18Ž wide x 5-1/4Ž high
- €Stop searching for cans & tools
- €Holds 4 cans.
- €Holds 4 tools.

Sprays & tools sold separately.

#CHM1



MOUNTS TWO WAYS!
Use the two mounting holes on the back for screws or magnets.

ONLY FROM PPE !

PART NO.	DESCRIPTION	QUANTITY PRICES	
		1-5	6+
CH4X4	CAN HOLDER	\$19.50 ea.	\$18.50 ea.
CHM1	MOUNTING MAGNET	\$6.75 ea.	\$6.60 ea.



SPRAY CAN HOLDERS WITH RARE EARTH MAGNETS 2 OR 4 CAN SIZES

CAN HEIGHTS ADJUSTABLE!

Sprays sold separately.

- €Holds 12,16 & 20 oz. cans.
- €Mount on machine or tool cart with rare earth magnets attached on the back.
- €Adjustable height with 1 pair of thumb screws per bracket that can be raised or lowered 3-3/4Ž by hand.
- €Powder coated steel.
- €Thin soft pads over magnets protect surface finish.
- €Keeps sprays handy - not on top of your hot machine and not on the floor.
- €Dimensions:
2 Can: 8Ž wide x 7-1/8Ž high.
4 Can: 16Ž wide x 7-1/8Ž high.
- €Stop searching for cans.
- €Safely holds cans away from heat.
- €Can also be wall mounted with the 2 key slots on back.
- €2 can holder, 2 magnets.
- €4 can holder, 4 magnets.
- €3Ž diameter holes.

PART NO.	DESCRIPTION	QUANTITY PRICES	
		1-5	6+
CH22RE	2 CAN HOLDER	\$18.25 ea.	\$17.35 ea.
CH44RE	4 CAN HOLDER	\$32.25 ea.	\$30.85 ea.



SPRAY CAN HOLDERS

- €All Stainless Steel.
- €Fits all can sizes.
- €Keeps cans from falling.
- €Holds cans within reach.
- €Keeps cans away from HOT surfaces!

Optional #CHM1 Mounting Magnet makes it portable.

Can Magnets designed for good hold, but easy release.

← 1/4Ž Key Slot with 3/8Ž dia. hole (2)

PART NO.	DESCRIPTION	QUANTITY PRICES	
		1-5	6+
CH588	CAN HOLDER	\$9.90 ea.	\$9.25 ea.
CHM1	MOUNTING MAGNET	\$6.75 ea.	\$6.60 ea.

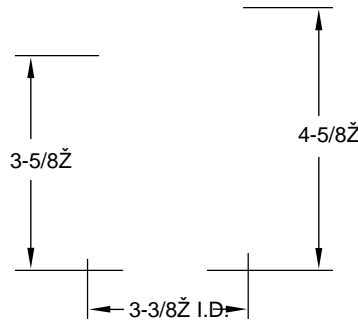

- €Holds up to 8 lbs.
- €Strong ceramic magnet coated to avoid scratching.
- €Sticks to any metal surface.
- €Made of high impact plastic.
- €Holds cans or cups.
- €Holds large size cans.

PART NO.	DESCRIPTION	QUANTITY PRICES	
		1-11	12+
W12525	MAGNETIC CAN/CUP HOLDER	\$5.40 ea.	\$5.15 ea.



PLASTIC PROCESS EQUIPMENT, INC.

E 8303 CORPORATE PARK DRIVE
A MACEDONIA, OHIO 44056-2300
S 216-367-7000 € FAX: 216-367-7022
T TOLL FREE: 800-321-0562

W 6385 MONTESSOURI STREET
E LAS VEGAS, NEVADA 89113-1186
S 702-433-6385 € FAX: 702-433-6388
T TOLL FREE: 800-258-8877

www.ppe.com
e-mail: sales@ppe.com
Toll Free: USA, Canada & Mexico
800-362-0706
Order Fax: 800-223-8305