

INSTRUCTIONS FOR FIXED ANGLE CONVEYOR

MODEL NO.

VICF

SERIAL NO.



PPE Conveyors are manufactured and sold direct by Plastic Process Equipment, Inc. We are not associated with any other manufacturer except Budget Molder's Supply, Inc. Always specify genuine PPE or Budget Hi-Line conveyors! Do not accept substitutes.

Made in the U.S.A. by Plastic Process Equipment, Inc. © copyright 2010



PLASTIC PROCESS EQUIPMENT, INC.

www.ppe.com • e-mail: sales@ppe.com

**PPE
WEST**

6385 Montessouri Street, Las Vegas, Nevada 89113
702-433-6385 • 800-258-8877 • Fax: 702-433-6388

**PPE
SOUTH**

11218 Challenger Avenue, Odessa, Florida 33556
727-834-8888 • 800-282-6783 • Fax: 727-834-8873

8303 CORPORATE PARK DRIVE, MACEDONIA (Cleveland), OHIO 44056, USA

216-367-7000 • Toll Free: 800-321-0562 • Fax: 216-367-7022 • Order Fax: 800-223-8305

Toll Free: USA, Canada & Mexico
800-362-0706

Thank you for purchasing a Fixed Angle Conveyor from Plastic Process Equipment. This instruction booklet is intended as a guide for your new product. If you have additional questions, contact Plastic Process Equipment, Inc. at 1-800-321-0562.

RECEIVING

Thoroughly inspect your new conveyor before unpacking for setup. Report any damage to the motor freight carrier; they are responsible for damages incurred during transit.

ATTENTION!!

Please read through the entire booklet first.

You must be trained and authorized by your employer in the proper installation operation, maintenance and setup of your new equipment. ***Safety First Always!***

SETUP

(REQUIRES TWO PEOPLE)

Your new conveyor is crated and shipped from the factory fully assembled .

After uncrating:

- 1) Adjust conveyor to required height.
- 2) Remember to lock the casters after adjusting the conveyor and setting it into position.

ELECTRICAL

- 1) Always use a grounded 120 volt outlet and a suitable three wire grounded extension cord.
- 2) All conveyors are equipped with a starter switch and an overload protection heater properly sized for the drive motor. The On/Off switch on some models is resettable, should the switch get overloaded for some reason it may be necessary to reset it before the conveyor will run again. See switch cover for reset instructions.

WARNING DRIVE MOTOR

The standard drive motor is not designed for repeated start stop operation, if you turn the conveyor on and off more than 10 times per minute you damage the motor by overheating. There are special order motors available for start/stop operations, please consult the factory.

CAUTION DURING USE AND OPERATION OF CONVEYOR

- Do not wear loose clothing or jewelry around the conveyor.
- Do not wear rings, necklaces, or jewelry.
- Long hair **must** be tied and netted.
- Keep all hands, arms, and fingers away from any moving parts except the conveyor belt surface.
- Never stand on the conveyor belt for any reason whatsoever.
- Do not operate any conveyor with the guards removed.
- Do not operate the conveyor with parts missing, removed, or in a disassembled state.
- Pay special attention to the ON-OFF switch location.
- Wear safety glasses if your company or process requires them.
- You must unplug the conveyor before performing any repairs or maintenance.
- If you are unsure about installation, operation, maintenance, or setup call PPE!

BELT ADJUSTMENT, TENSION & TRACKING

PPE conveyors feature automatic spring loaded belt tension adjustment. All conveyors and separators are thoroughly tested in our factory after final assembly. The belts are adjusted to track properly so **no adjustment will be necessary**. Because of the endless 2-ply monofilament belt (no lacing to snag or tear) and Vee-guide tracking, there should never be a tracking problem with a PPE conveyor.

LUBRICATION: CHAIN DRIVE UNITS

(BIC, FT, FS, VICB, PC 06, PC 12, PC 18, PC 24, PCS, PUC, VIB, ICG, PCS) PPE chain drive units use permanently lubricated drive chains that **do not** require lubrication. All bearings are permanently lubricated, therefore we do not provide a grease fitting.

BELT REPLACEMENT

(REQUIRES TWO PEOPLE)

- 1) Disconnect all power to the conveyor.
- 2) Remove the eight hopper bolts on top of frame (see **Figure 1**) and the two Allen head screws and the A-5470 plastic transition covers where the hopper meets the incline section.

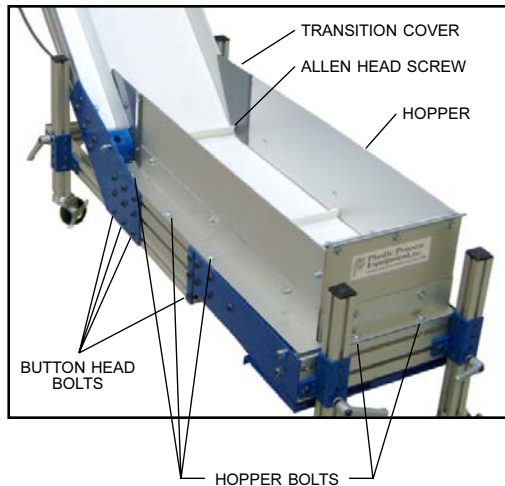

Figure 1

- 12) Remove plate on non-drive side (see **Figure 2**). **DO NOT REMOVE THE FRAME ATTACHMENT BRACKET!**

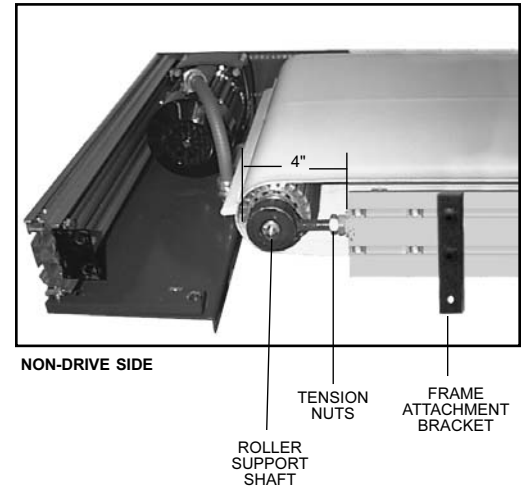

Figure 2

- 13) Free the top belt edges from under the transition rollers and free the bottom belt edges from within the frame track so the belt hangs below the frame.
- 14) While compressing the roller on the non-drive end, pull the belt half way up and off of the drive roller.
- 15) Continue compressing the non-drive roller while pulling the belt halfway off the non-drive end. When belt is halfway off both ends, it can be removed the rest of the way.

CAUTION:
ROLLER AND ENDS UNDER SPRING TENSION!

- 16) To reassemble conveyor, follow instructions in reverse order. When reinstalling the belt, the Vee-Guide on the bottom of the belt is seated in the groove of the rollers.
- 17) After installing the new belt and reassembling the conveyor, return conveyor to required height and angle of operation.

WARRANTY

All PPE Conveyors have a full **two year warranty**. This warranty doesn't include conveyor belts because they are subject to excessive wear damage and abuse by the user. This Warranty should not extend to goods subjected to misuse, abuse, neglect, accident or improper installation or maintenance, or products or goods which have been altered, modified or repaired by anyone other than seller or its authorized and approved representatives.

VICF CONVEYOR PARTS

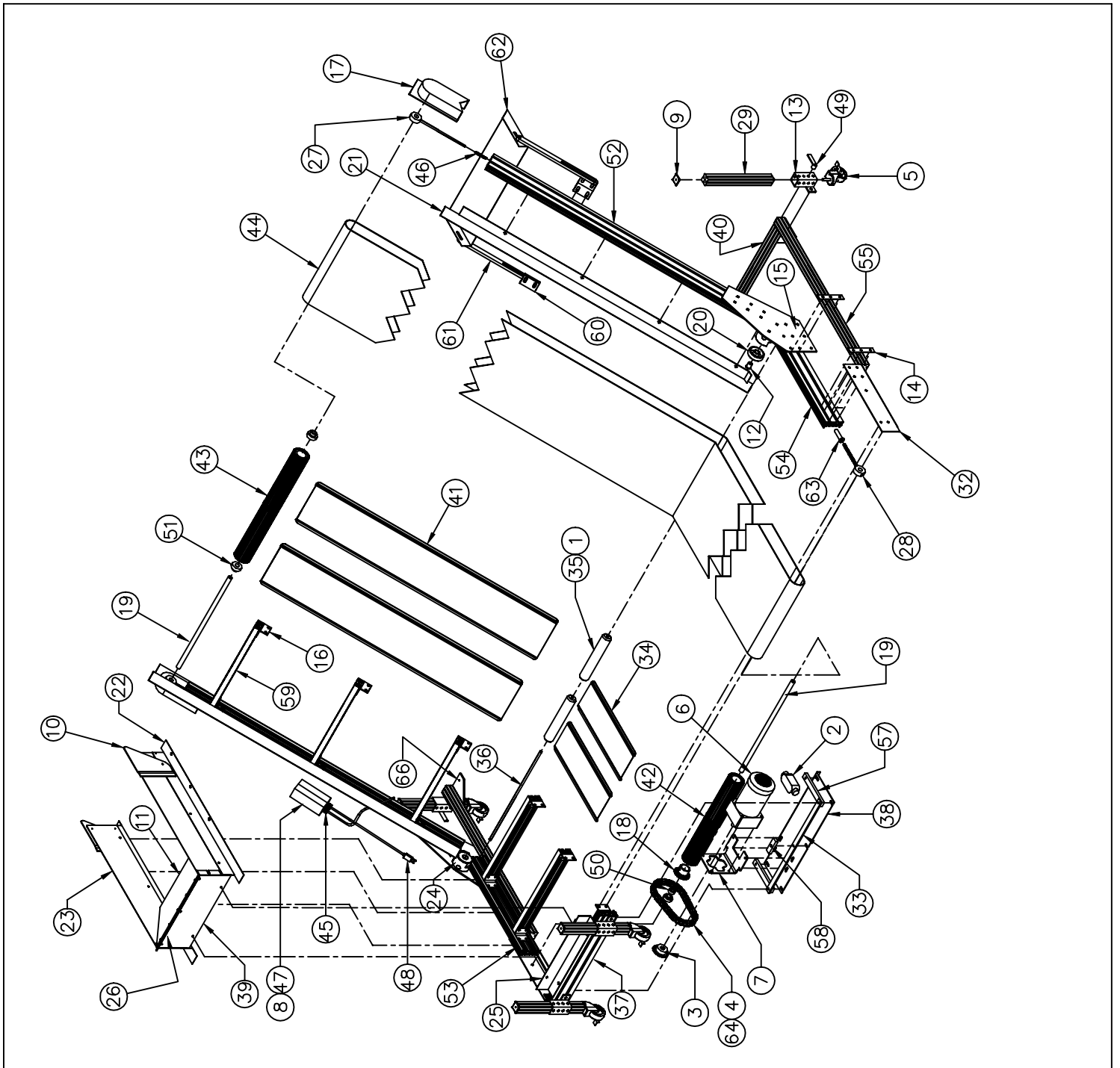

PLASTIC PROCESS EQUIPMENT, INC.

8303 Corporate Park Drive, Macedonia (CLEVELAND), OHIO 44056
(216) 367-7000 TOLL FREE: 800-321-0562 FAX (216) 367-7022 ORDER FAX: 800-223-8305 EMAIL: SALES@PPE.COM

6385 Montessouri Street, Las Vegas, Nevada 89113
(702) 433-6385 TOLL FREE: 800-258-8877
FAX: (702) 433-6388

11218 Challenger Ave., Odessa, FL 33556
(727) 834-8888 TOLL FREE: 800-282-6783
FAX: (727) 834-8873

VICF CONVEYORS

PARTS LIST 12"

09/17/15

10:35:17 AM

ID	P/N	DESCRIPTION	UOM
1	1416D-1/2	TRANSITION ROLLER END CAP FOR SIV/VIB	EA
2	30432	JUNCTION BOX	EA
3	35BS19HTX3/4	#35 HARDENED SPROCKET KEYED W/SET SCREW	EA
4	35C	#35 CHAIN PER FOOT	EA
5	CW4	CASTERS WITH LOCK	EA
6	6183	1/4HP GEARMOTOR DC VERSION OF 655 NEW #5044	EA
7	655L	L BRACKET FOR 655 MOTOR	EA
8	0791B	0791B BODINE VARIABLE SPEED CONTROL W/12FT CORD	EA
9	2030-3274	BLACK PLASTIC CAP FOR EXT1515 EXTRUSION	EA
10	A-5470	PLASTIC TRANSITION COVER FOR SIV/VIB (set)	EA
11	A-5474-12	PLASTIC FLAPPER 12" FOR SIV/VIB (WHITE)	EA
12 KIT	A-5476K	PLASTIC WHEEL, ROLLER HUB WITH STUD, WASHER, AND NUT (SET LEFT&RIGHT)	EA
13	A-10661	LEG BRACKET FOR VIC AND VICF	EA
14	A-10660	FRAME ATTACHMENT BRACKET FOR VIC	EA
15	A-10667	SWIVEL PLATE FOR VICF	EA
16	A-5486	FRAME "L" BRACKET FOR SI, SP, & SIV/VIB	EA
17	A-6850	PLASTIC BEARING COVER	EA
18	A-5959	MACHINED SPROCKET FOR CONVEYOR	EA
19	A-5982-12	SHAFTS FOR CONVEYORS 12"	EA
20	A-6987	TRANSITION ROLLER FOR VIB/SIV	EA
21	B-6885	UPPER SIDE RAILS ALUM FOR VIB (set)	SET
22	B-5441-3	ALUM SIDE RAIL FOR SIV (SET) , INCLUDES ANODIZE	SET
23	B-5442-3	ALUM LOWER SIDE RAIL FOR SIV/VIB (SET)	SET
24	B-5471	ALUM ROLLER COVER FOR SIV/VIB (SET)	EA
25	B-5472-12	ALUM FLAPPER ANGLE FOR SIV/VIB 12"	EA
26	B-5475-12	FLAPPER HINGE 12" FOR SIV/VIB	EA
27	B-10164	TENSION ADJUSTMENT ROD FOR SIV/VIB NEW STYLE 1/2"	EA
28	B-5479	TENSION ADJUSTMENT ROD FOR SI SIV/VIB & SP	EA
29	A-10654	EXTRUDED LEG FOR VIC VICF	EA
32	B-5490	DRIVE SIDE PLATE FOR SIV (SET)	SET
33	B-5491-12	PLASTIC END RAIL SPACER FOR SIV/VIB 12"	EA
34	B-5494-2-12G	GALV LOWER BEDDING FOR SIV/VIB 2' X 12"	EA
35	B-5504-12	TRANSITION ROLLER TUBE FOR SIV/VIB 12"	EA
36	B-5516-12	TRANSITION ROLLER SHAFT FOR SIV/VIB 12"	EA
37	B-5566-12	FRAME END FOR SIV/VIB 12"	EA
38	B-5623-12	MOTOR BASE PLATE 12" FOR SIV/VIB	EA
39	B-5626-12	ALUM FLAPPER MOUNT 12" FOR SIV/VIB (INCLUDING ANODIZE)	EA
40	A-10655-12	REAR STAND CROSSBRACE FOR VIC 12"	EA
41	B-7026-12G	GALV BEDDING FOR VIB	EA
42	B-5984-12	DRIVE ROLLER (DOES NOT INCLUDE BEARINGS) 12"	EA
43	B-5998-12	IDLER ROLLER (DOES NOT INCLUDE BEARINGS) 12"	EA
44	BELT	BELT	EA
45	SEC50BA	STRAIN RELIEF FOR ELECTRIC CORD	EA
46	DS-233	BELT ADJUSTMENT SPRINGS 11" NEW STYLE 9/07	EA
47	FUSE	FUSE	EA
48	K5152	K5152 12' POWER CORD	EA
49	64835K69	TEAR DROP HANDLE	EA
50	RAL012NPP+COL	SPROCKET BEARING w/COLLAR FOR SP, SI, SIV/VIB	EA
51	YA012RR	BEARINGS FOR SP, SI, SIV/VIB CONVEYOR	EA
52	B-7027	UPPER FRAME SIDE FOR VIB	EA
53	B-7028	HORIZONTAL RIGHT SIDE FRAME FOR VIB	EA
54	B-7038	HORIZONTAL LEFT SIDE FRAME FOR VIB	EA
55	A-10656-36	SIDE BASE FRAME FOR VICF 36"	EA
57	A-6549A	STEEL MOTOR PLATE SPACER FOR SIV/VIB	EA
58	A-6549B	STEEL MOTOR PLATE SPACER FOR SIV/VIB	EA
59	B-5985-12	CROSS MEMBER 12"	EA
60	A-6902	CONVEYOR TRAY BRACKET	EA
61	B-4016	FS ATTACHMENT ADJ BAR (set)	EA
62	A-6453-12	SS TRAY 12"	EA
63	A-5980	PLASTIC BUSHING	EA
64	35ML	#35 MASTER LINK	EA
66	EX4351	JOINING PLATE FOR EXT1515	EA

SEE BELT SHEET FOR BELTS