

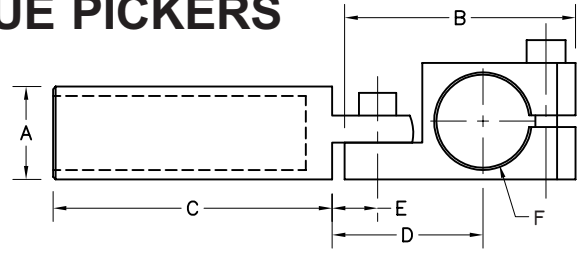

END OF ARM TOOLING PARTS FOR ROBOTIC SPRUE PICKERS

Elbow Arms

These Elbow Arms are made of lightweight aluminum. The head pivots 90° in either direction for full range of mounting options.



ELBOW ARM CLAMP



SUSPENSION ARM
ROTATING & NON-ROTATING



THREADED SUSPENSION ARM
ROTATING & NON-ROTATING



ELBOW SUSPENSION ARM CLAMP
NON-ROTATING



PLAIN ARM



TOP220001



TOP22000



TOP22001



TOP520125P

PART NO.	DESCRIPTION	A	B	C	D	E	F	STROKE	PRICE
TOP22060	Elbow Arm Clamp - Short	10mm	32mm	35mm	20mm	7.5mm	10mm	-	\$19.97
TOP22120	Elbow Arm Clamp - Long	10mm	32mm	82mm	20mm	7.5mm	10mm	-	\$23.85
TOP22100	Elbow Arm Clamp - Short	20mm	50mm	60mm	33mm	9.5mm	20mm	-	\$31.00
TOP22190	Elbow Arm Clamp - Long	20mm	50mm	135mm	33mm	9.5mm	20mm	-	\$32.75
TOP52020	20mm Suspension Arm - Rotating	20mm	20mm	75mm	20mm	14mm	M5	20mm	\$31.85
TOP52030	20mm Suspension Arm - Rotating	20mm	20mm	85mm	20mm	14mm	M5	30mm	\$33.96
TOP52040	20mm Suspension Arm - Rotating	20mm	20mm	95mm	20mm	14mm	M5	40mm	\$36.10
TOP52050	20mm Suspension Arm - Rotating	20mm	20mm	105mm	20mm	14mm	M5	50mm	\$38.22
TOPNR52020	20mm Suspension Arm - Non-Rotating	20mm	20mm	75mm	20mm	14mm	M5	20mm	\$35.94
TOPNR52030	20mm Suspension Arm - Non-Rotating	20mm	20mm	85mm	20mm	14mm	M5	30mm	\$37.92
TOPNR52040	20mm Suspension Arm - Non-Rotating	20mm	20mm	95mm	20mm	14mm	M5	40mm	\$40.15
TOPNR52050	20mm Suspension Arm - Non-Rotating	20mm	20mm	105mm	20mm	14mm	M5	50mm	\$42.38
TOP52020T	M20 Threaded Suspension Arm - Rotating	20mm	20mm	75mm	20mm	14mm	M5	20mm	\$34.46
TOP52030T	M20 Threaded Suspension Arm - Rotating	20mm	20mm	85mm	20mm	14mm	M5	30mm	\$36.62
TOP52040T	M20 Threaded Suspension Arm - Rotating	20mm	20mm	95mm	20mm	14mm	M5	40mm	\$38.77
TOP52050T	M20 Threaded Suspension Arm - Rotating	20mm	20mm	105mm	20mm	14mm	M5	50mm	\$40.92
TOPNR52020T	M20 Threaded Suspension Arm - Non-Rotating	20mm	20mm	75mm	20mm	14mm	M5	20mm	\$38.70
TOPNR52030T	M20 Threaded Suspension Arm - Non-Rotating	20mm	20mm	85mm	20mm	14mm	M5	30mm	\$40.98
TOPNR52040T	M20 Threaded Suspension Arm - Non-Rotating	20mm	20mm	95mm	20mm	14mm	M5	40mm	\$43.26
TOPNR52050T	M20 Threaded Suspension Arm - Non-Rotating	20mm	20mm	105mm	20mm	14mm	M5	50mm	\$45.54
TOP52020EL	20mm Elbow Suspension Arm Clamp - Non-Rotating	20mm	50mm	75mm	30mm	14mm	20mm	20mm	\$43.69
TOP52030EL	20mm Elbow Suspension Arm Clamp - Non-Rotating	20mm	50mm	85mm	30mm	14mm	20mm	30mm	\$43.69
TOP52040EL	20mm Elbow Suspension Arm Clamp - Non-Rotating	20mm	50mm	95mm	30mm	14mm	20mm	40mm	\$45.87
TOP52050EL	20mm Elbow Suspension Arm Clamp - Non-Rotating	20mm	50mm	105mm	30mm	14mm	20mm	50mm	\$45.87
TOP221030	10mm Plain Arm - Short	10mm	-	30mm	-	5mm	M5	-	\$10.50
TOP221060	10mm Plain Arm - Long	10mm	-	60mm	-	5mm	M5	-	\$10.67
TOP222050	20mm Plain Arm - Short	20mm	-	50mm	-	9mm	1/8G	-	\$16.38
TOP2220100	20mm Plain Arm - Long	20mm	-	100mm	-	9mm	1/8G	-	\$16.74
TOP220001	20mm Elbow Only	-	50mm	-	-	-	20mm	-	\$12.74
TOP22000	10mm Frame Mount	-	30mm	-	-	-	10mm	-	\$10.74
TOP22001	20mm Frame Mount	-	41mm	-	-	-	20mm	-	\$12.74
TOP520125P	M5 X 1/8G Adapter for Suspensions Arms	-	22mm	-	-	-	1/8G	-	\$4.67

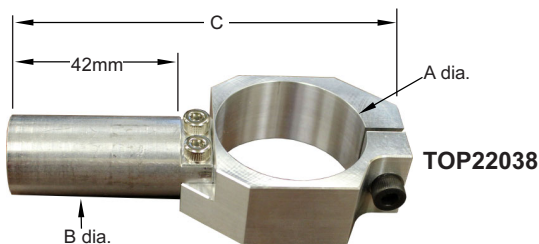

Nipper Holders

These Nipper Holders are designed to hold standard size pneumatic nippers. Constructed of lightweight aluminum they are very rigid to provide precise placement of the nipper.

PART NO.	DESCRIPTION	A	B	C	PRICE
TOP22038	1.5" Nipper Holder (for SM-100)	1.5"	20mm	99mm	\$37.60
TOP22020	45mm Nipper holder	45mm	20mm	107mm	\$37.60
TOP22030	55mm Nipper Holder	55mm	20mm	118mm	\$41.15