

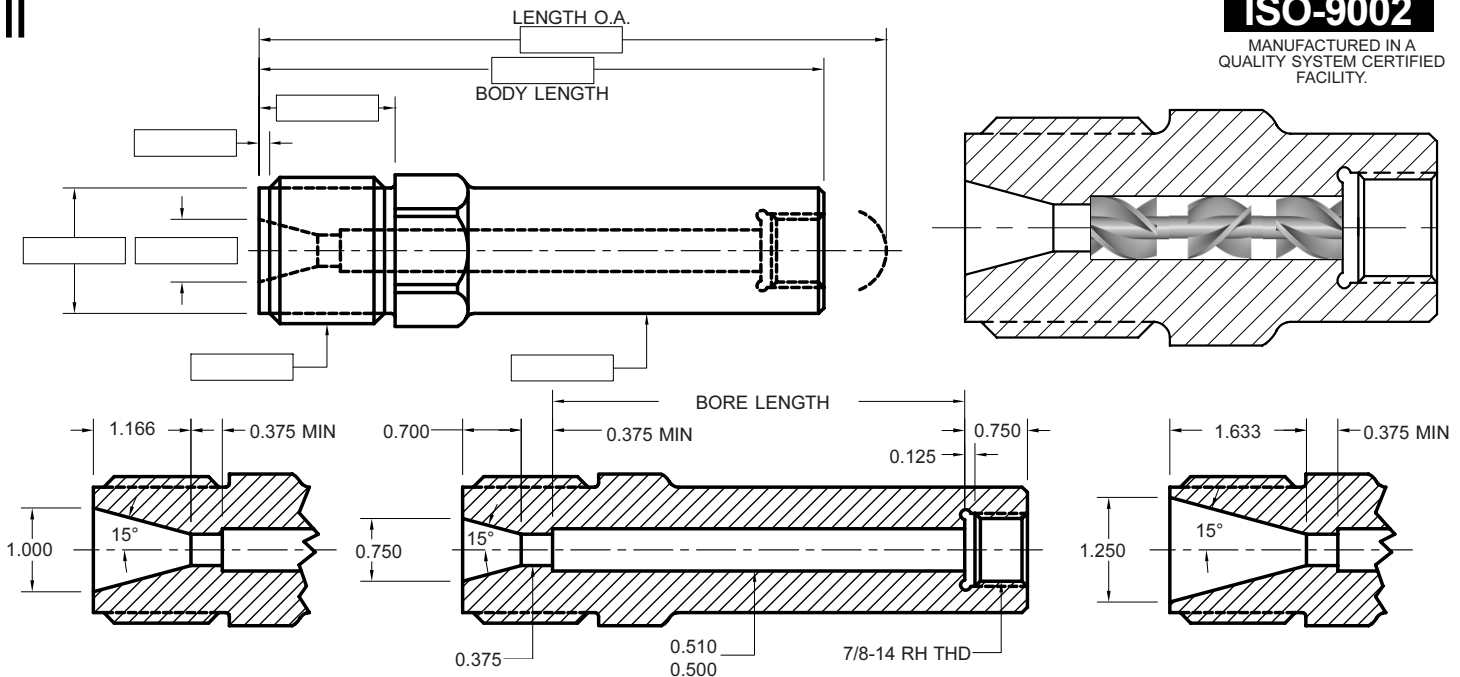

COLOR MIXING NOZZLE Order Guide

FOR HELIX MIXER SEGMENTS

ISO-9002
 MANUFACTURED IN A
 QUALITY SYSTEM CERTIFIED
 FACILITY.



| BODY LENGTH | REAR OPENING | BORE LENGTH | # OF SEGMENTS |
|-------------|-----------------|---------------|-----------------------|
| 4.250 | 0.750 (19.05mm) | 2.025/2.030 | 3 (2 END, 1 MIDDLE) |
| | 1.000 (25.4mm) | NA | NA |
| | 1.250 (31.75mm) | NA | NA |
| 5.250 | 0.750 (19.05mm) | 2.775/2.780 | 4 (2 END, 2 MIDDLE) |
| | 1.000 (25.4mm) | 2.775/2.780 | 4 (2 END, 2 MIDDLE) |
| | 1.250 (31.75mm) | 2.025/2.030 | 3 (2 END, 1 MIDDLE) |
| 6.250 | 0.750 (19.05mm) | 4.275/4.280 | 6 (2 END, 4 MIDDLE) |
| | 1.000 (25.4mm) | 3.525/3.530 | 5 (2 END, 3 MIDDLE) |
| | 1.250 (31.75mm) | 2.775/2.780 | 4 (2 END, 2 MIDDLE) |
| 7.250 | 0.750 (19.05mm) | 5.025/5.030 | 7 (2 END, 5 MIDDLE) |
| | 1.000 (25.4mm) | 4.275/4.280 | 6 (2 END, 4 MIDDLE) |
| | 1.250 (31.75mm) | 4.275/4.280 | 6 (2 END, 4 MIDDLE) |
| 8.250 | 0.750 (19.05mm) | 5.775/5.780 | 8 (2 END, 6 MIDDLE) |
| | 1.000 (25.4mm) | 5.775/5.780 | 8 (2 END, 6 MIDDLE) |
| | 1.250 (31.75mm) | 5.025/5.030 | 7 (2 END, 5 MIDDLE) |
| 9.250 | 0.750 (19.05mm) | 7.275/7.280 | 10 (2 END, 8 MIDDLE) |
| | 1.000 (25.4mm) | 6.525/6.530 | 9 (2 END, 7 MIDDLE) |
| | 1.250 (31.75mm) | 5.775/5.780 | 8 (2 END, 6 MIDDLE) |
| 10.250 | 0.750 (19.05mm) | 8.025/8.030 | 11 (2 END, 9 MIDDLE) |
| | 1.000 (25.4mm) | 7.275/7.280 | 10 (2 END, 8 MIDDLE) |
| | 1.250 (31.75mm) | 7.275/7.280 | 10 (2 END, 8 MIDDLE) |
| 11.250 | 0.750 (19.05mm) | 8.775/8.780 | 12 (2 END, 10 MIDDLE) |
| | 1.000 (25.4mm) | 8.775/8.780 | 12 (2 END, 10 MIDDLE) |
| | 1.250 (31.75mm) | 8.025/8.030 | 11 (2 END, 9 MIDDLE) |
| 12.250 | 0.750 (19.05mm) | 10.275/10.280 | 14 (2 END, 12 MIDDLE) |
| | 1.000 (25.4mm) | 9.525/9.530 | 13 (2 END, 11 MIDDLE) |
| | 1.250 (31.75mm) | 8.775/8.780 | 12 (2 END, 10 MIDDLE) |
| 13.250 | 0.750 (19.05mm) | 11.025/11.030 | 15 (2 END, 13 MIDDLE) |
| | 1.000 (25.4mm) | 10.275/10.280 | 14 (2 END, 12 MIDDLE) |
| | 1.250 (31.75mm) | 10.275/10.280 | 14 (2 END, 12 MIDDLE) |
| 14.250 | 0.750 (19.05mm) | 11.775/11.780 | 16 (2 END, 14 MIDDLE) |
| | 1.000 (25.4mm) | 11.775/11.780 | 16 (2 END, 14 MIDDLE) |
| | 1.250 (31.75mm) | 11.025/11.030 | 15 (2 END, 13 MIDDLE) |
| 15.250 | 0.750 (19.05mm) | 13.275/13.280 | 18 (2 END, 16 MIDDLE) |
| | 1.000 (25.4mm) | 12.525/12.530 | 17 (2 END, 15 MIDDLE) |
| | 1.250 (31.75mm) | 11.775/11.780 | 16 (2 END, 14 MIDDLE) |



PLASTIC PROCESS EQUIPMENT, INC.

EAST 8303 CORPORATE PARK DRIVE
 MACEDONIA, OHIO 44056
 216-367-7000 • FAX: 216-367-7022
 TOLL FREE: 800-321-0562

WEST 6385 MONTESSOURI STREET
 LAS VEGAS, NEVADA 89113
 702-433-6385 • FAX: 702-433-6388
 TOLL FREE: 800-258-8877

www.ppe.com
 e-mail: sales@ppe.com

Toll Free: USA, Canada & Mexico
800-362-0706

Order Fax: 800-223-8305