



THERMOCOUPLE BAYONET ADAPTORS

UNIVERSAL ADAPTORS TO FIT STANDARD THERMOCOUPLES
AMERICAN — METRIC — BRITISH STANDARD

UNIVERSAL ADAPTORS TO FIT STANDARD THERMOCOUPLES.

PART NO.	THREAD SIZE	L DIM. LENGTH	# PINS	QUANTITY PRICING	
				1-11	12+
78-T	1/8-27 N.P.T	7/8"	1	\$1.20	\$1.10
114-T	1/8-27 N.P.T	1-1/4"	1	1.35	1.25
214-T	1/8-27 N.P.T	2-1/4"	1	1.75	1.65
300-T	1/8-27 N.P.T	3"	1	3.05	2.85
350-T	1/8-27 N.P.T	3-1/2"	1	3.35	3.15
78-S	3/8-24 N.F.	7/8"	1	1.20	1.10
114-S	3/8-24 N.F.	1-1/4"	1	1.35	1.25
214-S	3/8-24 N.F.	2-1/4"	1	1.75	1.65
300-S	3/8-24 N.F.	3"	1	3.05	2.85
78-BS	1/8-28 B.S.P.T	7/8"	1	2.75	2.50
114-BS	1/8-28 B.S.P.T	1-1/4"	1	3.25	3.00
111-M	10x1.5mm	1-1/2"	1	3.30	3.15
212-M	10X1.5mm	2-1/2"	1	4.50	4.25
112-M	12X1mm	1-1/2"	1	3.35	3.10
213-M	12X1mm	2-1/2"	1	4.65	4.40
314-M	12X1.75mm	1-1/2"	1	3.05	2.85
415-M	12X1.75mm	2-1/2"	1	4.30	4.05
113-M	14X1.5mm	1-1/2"	1	3.30	3.10
238-M	14X1.5mm	2-3/8"	1	4.75	4.40

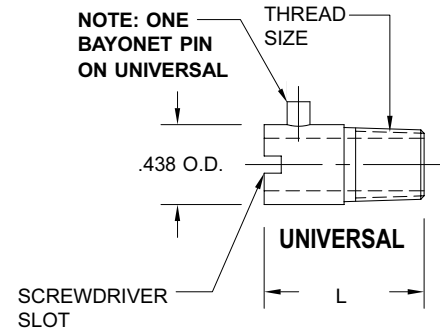

These Universal Bayonet Adaptors are available with Metric threads and a .438 Body Diameter. This allows you to use American Standard lower priced Thermocouples in your Metric threaded T.C. holes.

METRIC ADAPTORS TO FIT METRIC THERMOCOUPLES

A DIM	PART NO.	THREAD SIZE	L DIM. LENGTH	# PINS	QUANTITY PRICING	
					1-11	12+
12mm/.472	M121	12X1mm	1-1/2"	2	\$3.85	\$3.65
12mm/.472	M122	12X1mm	2-1/2"	2	5.25	5.00
12mm/.472	M123	12X1.5mm	1-1/2"	2	3.55	3.35
12mm/.472	M125	12X1.5mm	2-1/2"	2	5.10	4.85
12mm/.472	M127	12X1.75mm	1-1/2"	2	3.05	2.85
12mm/.472	M129	12X1.75mm	2-1/2"	2	4.30	4.05
14mm/.551	M141	14X1.5mm	1-1/2"	2	3.95	3.75
14mm/.551	M142	14X1.5mm	2-1/2"	2	5.45	5.25

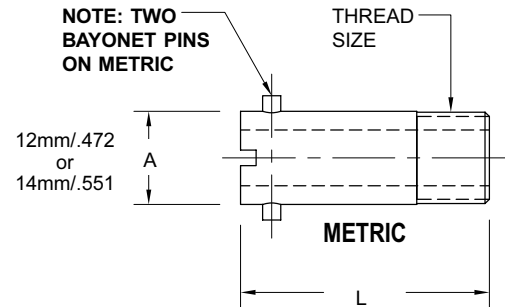

METRIC TO AMERICAN CONVERSION ADAPTORS

NEW

PART NO.	METRIC THREAD SIZE	QUANTITY PRICING	
		1-11	12+
CAM10150	10X1.5mm	\$3.60	\$3.40
CAM14150	14X1.5mm	3.60	3.40
CAM12175	12X1.75mm	3.60	3.40

This allows you to use American Standard lower priced Thermocouples in your Metric threaded T.C. holes.

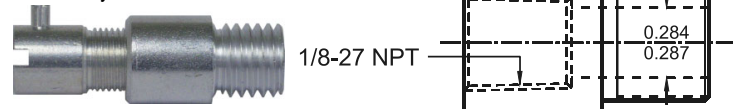

T/C BAYONET ADAPTOR WITH STRAP CLAMP

FOR SURFACE MOUNTING
NO DRILLING REQUIRED

PART NO.	CLAMPING RANGE	ADAPTOR O.A.L.	PRICE EACH
TCHSS-101	9/16" to 1-1/16"	1-1/4"	\$5.00
TCHSS-241	1-1/16" to 2"	1-1/4"	5.00
TCHSS-361	1-3/4" to 2-1/2"	1-1/4"	5.00
TCHSS-481	2-1/2" to 3-1/2"	1-1/4"	5.00
TCHSS-641	3-3/8" to 4-1/2"	1-1/4"	6.00
TCHSS-961	4-1/2" to 6-1/2"	1-1/4"	6.00
TCHSS-102	9/16" to 1-1/16"	2"	6.00
TCHSS-242	1-1/16" to 2"	2"	6.25
TCHSS-362	1-3/4" to 2-1/2"	2"	6.25
TCHSS-482	2-1/2" to 3-1/2"	2"	6.25
TCHSS-642	3-3/8" to 4-1/2"	2"	6.25
TCHSS-962	4-1/2" to 6-1/2"	2"	6.25

- Designed for surface applications where a drilled thermocouple hole is impractical.
- Worm gear hose clamp.
- 9/16" wide clamp with 7/16" hexagon and screw drive slot.
- Two adaptor lengths.
- Adaptor body dia. = .438

