



# FORGED STEEL EYE BOLTS

**MATERIAL: C 1030 HEAT TREATED QUENCHED AND DRAWN  
TENSILE: 65,000 PSI MINIMUM — YIELD: 30,000 PSI MINIMUM**



## SHOULDER PATTERN EYEBOLT

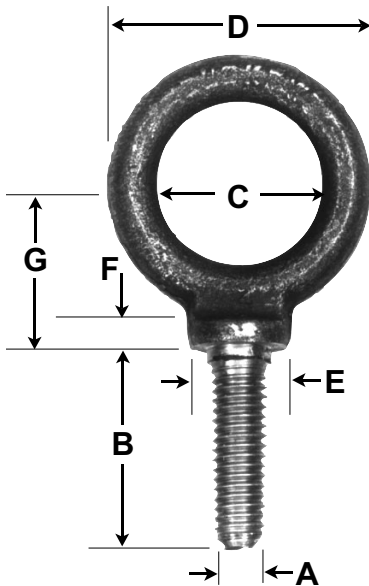

- **MADE IN THE U.S.A.**
- **HIGHER WORK LOADS THAN THE COMPETITION**
- **BETTER QUALITY**

### APPLICATION DATA:

1. Do not use eyebolts on angular lifts unless absolutely necessary. Loading must never be made at an angle greater than 45° from bolt centerline. At an angle of 45° rated capacity is reduced to 1/4 of tabulated value. For angular lifts, the swivel hoist ring is recommended.
2. Loads should always be applied to eyebolts in the plane of the eye, not at some angle to this plane.
3. Shoulder eyebolts must be properly seated (shoulder bear firmly against the mating part) otherwise the working loads must be reduced substantially. A washer or spacer may be required for proper seating.
4. No greater stress should be allowed than that given under safe working load in each of the tables of dimensional data.
5. To obtain greatest strength from an eyebolt, it must fit reasonably tight in the hole into which it is screwed to prevent unscrewing due to twist of cable. Tightness and seating must be checked after initial load.
6. Eyebolts should never be painted or otherwise coated when used for lifting, as such coatings will very likely cover up flaws.
7. To attain the safe working loads listed for regular eyebolts, 90 percent of the threaded length must be engaged.

"A" Nom. Shank Dia.	"B" Length of Shank	"C" Eye I.D.	"D" Eye O.D.	"E" Shldr. Dia.	"F" Shldr. Hgt.	"G" Eye to Base of Shldr.	Thread Size 2A	CAPACITY lbs.	PART NO.	PRICE EACH
								Safe Working Load		
1/4"	1"	3/4"	1-3/16"	17/32"	5/32"	13/16"	1/4-20	500	3025	\$1.85
5/16"	1-1/8"	7/8"	1-7/16"	19/32"	11/64"	31/32"	5/16-18	900	3031	1.95
3/8"	1-1/4"	1"	1-21/32"	11/16"	3/16"	1-5/32"	3/8-16	1,300	3037	2.00
7/16"	1-3/8"	1-3/32"	1-27/32"	25/32"	13/64"	1-5/16"	7/16-14	1,800	3043	2.90
1/2"	1-1/2"	1-3/16"	2-1/16"	7/8"	7/32"	1-7/16"	1/2-13	2,400	3050	2.55
5/8"	1-3/4"	1-3/8"	2-1/2"	1-1/16"	1/4"	1-23/32"	5/8-11	4,000	3062	4.10
3/4"	2"	1-1/2"	2-13/16"	1-1/4"	5/16"	1-29/32"	3/4-10	5,000	3075	5.30
7/8"	2-1/4"	1-11/16"	3-1/4"	1-7/16"	3/8"	2-3/16"	7/8-9	7,000	3087	7.45
1"	2-1/2"	1-13/16"	3-9/16"	1-9/16"	13/32"	2-13/32"	1-8	9,000	3100	9.65
1-1/8"	2-3/4"	2"	4"	1-11/16"	7/16"	2-23/32"	1-1/8-7	12,000	3112	14.75
1-1/4"	3"	2-3/16"	4-7/16"	1-7/8"	1/2"	2-15/16"	1-1/4-7	15,000	3125	19.45
1-1/2"	3-1/2"	2-1/2"	5-3/16"	2-3/16"	9/16"	3-7/16"	1-1/2-6	21,000	3150	38.80
1-3/4"	3-3/4"	2-7/8"	6-1/16"	2-1/2"	5/8"	3-31/32"	1-3/4-5	28,000	3175	56.05
2"	4"	3-1/4"	6-7/8"	2-7/8"	3/4"	4-1/2"	2-4-1/2	38,000	3200	78.60

### METRIC (dimensions in mm) Material- Carbon Steel C15 Drop Forged and Heat treated

M8	13	20	36	20	n/a	18	M8X1.25	300	M8EB	\$3.75
M10	17	25	45	25	n/a	22.5	M10X1.5	500	M10EB	4.00
M12	20.5	30	54	30	n/a	26	M12X1.75	720	M12EB	4.00
M16	27	35	63	35	n/a	30.5	M16X2.0	1,500	M16EB	5.00
M20	30	40	72	40	n/a	35	M20X2.5	2,600	M20EB	9.35
M24	36	50	90	50	n/a	45	M24X3.0	3,900	M24EB	13.00
M30	45	60	108	65	n/a	55	M30X3.5	7,900	M30EB	25.00
M36	54	70	126	75	n/a	65	M36X4.0	11,200	M36EB	38.00
M42	63	80	144	85	n/a	75	M42X4.5	15,000	M42EB	70.20
M48	68	90	166	100	n/a	85	M48X5.0	18,900	M48EB	101.70
M56	78	100	184	110	n/a	95	M56X5.5	25,300	M56EB	218.55
M64	90	110	206	120	n/a	100	M64X6.0	35,200	M64EB	315.00



## PLASTIC PROCESS EQUIPMENT, INC.

www.ppe.com • e-mail: sales@ppe.com

6385 Montessouri Street, Las Vegas, Nevada 89113  
PPE WEST 702-433-6385 • 800-258-8877 • Fax: 702-433-6388

11218 Challenger Avenue, Odessa, Florida 33556  
PPE SOUTH 727-834-8888 • 800-282-6783 • Fax: 727-834-8873

8303 CORPORATE PARK DRIVE, MACEDONIA (Cleveland), OHIO 44056, USA

PPE 216-367-7000 • Toll Free: 800-321-0562 • Fax: 216-367-7022 • Order Fax: 800-223-8305

Toll Free: USA, Canada & Mexico  
**800-362-0706**