



ISO-9000
MANUFACTURED IN A
QUALITY SYSTEM CERTIFIED
FACILITY.

HEX SOCKET HEAD CAP SCREWS

KNURLED HEADS • HEAT-TREATED ALLOY STEEL

CLASS 3A THREADS



TENSILE STRENGTH:
UP TO 1/2" DIA. 180,000 P.S.I.
5/8" OR LARGER 170,000 P.S.I.

★ = ONLY SOLD IN
BOX QUANTITY

DIA.	LENGTH (IN.)	COARSE THREADS			FINE THREADS			QTY PER BOX
		THD'S PER IN.	PPE PART NO.	PRICE EACH	THD'S PER IN.	PPE PART NO.	PRICE EACH	
1-1/2" (1.500") HEX KEY 1"	3"	6	★ SH112300C	\$12.651	-	-	-	BULK
	3-1/2"	6	★ SH112312C	\$15.529	-	-	-	BULK
	4"	6	SH112400C	\$16.781	-	-	-	BULK
	4-1/2"	6	★ SH112412C	\$17.954	-	-	-	BULK
	5"	6	SH112500C	\$16.685	-	-	-	BULK
	5-1/2"	6	★ SH112512C	\$18.400	-	-	-	BULK
	6"	6	★ SH112600C	\$21.712	-	-	-	BULK
	6-1/2"	6	★ SH112612C	\$21.947	-	-	-	BULK
	7"	6	★ SH112700C	\$23.280	-	-	-	BULK
	8"	6	★ SH112800C	\$27.528	-	-	-	BULK
	9"	6	★ SH112900C	\$29.869	-	-	-	BULK
	10"	6	SH1121000C	\$32.735	-	-	-	BULK
	12"	6	SH1121200C	\$40.224	-	-	-	BULK



HEX SOCKET HEAD STRIPPER BOLTS

CLASS FIT 3A - HARDNESS Rc 36-43

SHOULDER LENGTH	PRICING (EA. BOLT)					
	SHOULDER DIAMETER					
	1/4"	5/16"	3/8"	1/2"	5/8"	3/4"
3/8"	\$0.48	\$0.53	\$0.61			
1/2"	\$0.49	\$0.53	\$0.63	\$1.16		
5/8"	\$0.49	\$0.54	\$0.63	\$1.22		
3/4"	\$0.50	\$0.57	\$0.63	\$1.22		
1"	\$0.53	\$0.55	\$0.68	\$1.25		
1-1/4"	\$0.59	\$0.59	\$0.70	\$1.31	\$2.10	
1-1/2"	\$0.63	\$0.64	\$0.74	\$1.35	\$2.21	\$3.23
1-3/4"		\$0.67	\$0.79	\$1.42	\$2.31	\$3.33
2"		\$0.71	\$0.84	\$1.44	\$2.33	\$3.45
2-1/4"			\$0.90	\$1.63	\$2.35	\$3.59
2-1/2"			\$1.03	\$1.70	\$2.74	\$3.74
2-3/4"			\$1.16	\$1.84	\$3.01	\$4.11
3"			\$1.34	\$1.68	\$2.85	\$4.28
3-1/4"			\$1.40	\$2.09	\$3.13	\$4.73
3-1/2"			\$1.66	\$2.22	\$3.38	\$4.93
3-3/4"			\$1.74	\$2.26	\$3.71	\$5.61
4"			\$1.92	\$2.69	\$3.86	\$5.66
4-1/4"				\$3.05	\$4.28	\$6.14
4-1/2"				\$3.35	\$4.34	\$6.22
4-3/4"				\$3.57	\$4.94	\$6.89
5"				\$3.42	\$4.97	\$6.97
5-1/2"					\$5.69	\$9.56
6"					\$6.32	\$10.60

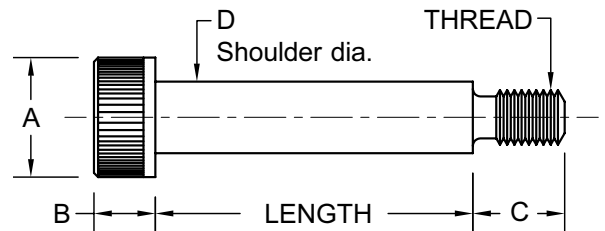

D SHOULDER DIA	THREAD	A (max)	B	C
1/4"	10-24	.375	.188	.375
5/16"	1/4-20	.438	.219	.438
3/8"	5/16-18	.562	.250	.500
1/2"	3/8-16	.750	.312	.625
5/8"	1/2-13	.875	.375	.750
3/4"	5/8-11	1.000	.500	.875

TO DETERMINE PART NUMBER:

SHSB + Shoulder Dia. + Length

Example: For a 3/8" dia. x 3-1/4" long bolt,
the part number would be **SHSB38314**.

Prices are each bolt.

Box Quantities: 25 up to 5/8" x 3", 10 5/8" x 3-1/4" up to 3/4" x 6"



PLASTIC PROCESS EQUIPMENT, INC.

www.ppe.com • e-mail: sales@ppe.com

PPE WEST 6385 Montessouri Street, Las Vegas, Nevada 89113
702-433-6385 • 800-258-8877 • Fax: 702-433-6388

PPE SOUTH 11218 Challenger Avenue, Odessa, Florida 33556
727-834-8888 • 800-282-6783 • Fax: 727-834-8873

8303 CORPORATE PARK DRIVE, MACEDONIA (Cleveland), OHIO 44056, USA

Toll Free: USA, Canada & Mexico
800-362-0706

216-367-7000 • Toll Free: 800-321-0562 • Fax: 216-367-7022 • Order Fax: 800-223-8305