



DATE INSERTS

MOLD DAY, MONTH AND YEAR DIRECTLY ON PART

ISO-9001
MANUFACTURED IN A
QUALITY SYSTEM CERTIFIED
FACILITY.

CUMSA

FEATURES

- Allows adjustment while mold is in the machine (observe the machine manufacturers safety instructions).
- Date stamp body is permanent; only the center insert must be changed (body is drive-in press fit).
- Complete clarity of engraving.
- Made from AISI 420 stainless, 50-55 Rc.
- Eight diameters available: 4-5-6-8-10-12-16 & 20 mm.
- Two insert styles - Month and 31 Day.



HOLE DIMENSIONS & INSTALLATION

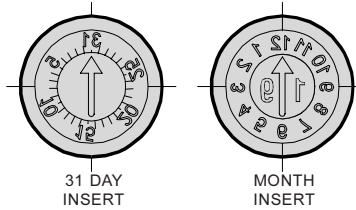
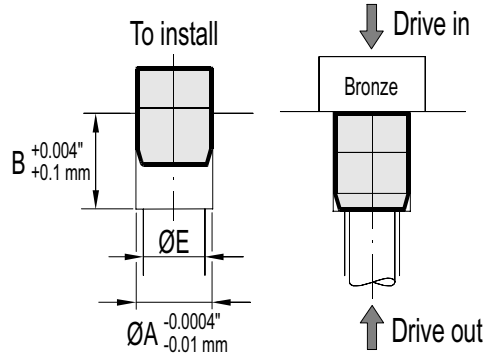

INSERT DIMENSIONS

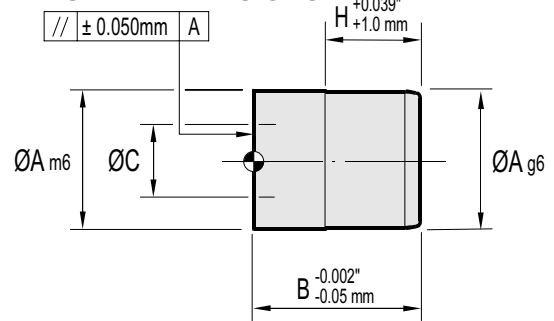

ARROW DIMENSIONS

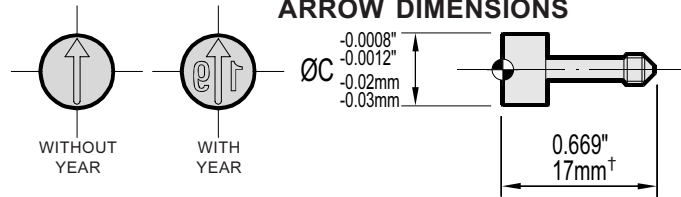

Drill a hole per the specifications listed. Insert has an undersized portion to allow partial entry into the drilled hole. Use a bronze block against the insert face and drive down into position. To remove, drive out from the rear.

DIMENSIONS & TOLERANCES

† on 2.2 & 3.0 mm arrows, length is 7.5 mm.

ØA		m6 TOLERANCE		g6 TOLERANCE		B		ØC		ØE		H	
mm	inches	mm	inches	mm	inches	mm	inches	mm	inches	mm	inches	mm	inches
4.0	0.1575	+0.004	+0.0001	-0.004	-0.0001	12.0	0.4724	2.2	0.0867	2.5	0.0984	5.0	0.1969
		+0.012	+0.0005	-0.012	-0.0005								
5.0	0.1969	+0.004	+0.0001	-0.004	-0.0001	12.0	0.4724	3.0	0.1181	3.5	0.1378	5.0	0.1969
		+0.012	+0.0005	-0.012	-0.0005								
6.0	0.2362	+0.006	+0.0002	-0.005	-0.0002	20.0	0.7874	3.2	0.1260	4.0	0.1575	12.0	0.4724
		+0.015	+0.0006	-0.014	-0.0006								
8.0	0.3150	+0.006	+0.0002	-0.005	-0.0002	20.0	0.7874	4.7	0.1850	6.0	0.2362	12.0	0.4724
		+0.015	+0.0006	-0.014	-0.0006								
10.0	0.3937	+0.007	+0.0003	-0.006	-0.0002	20.0	0.7874	5.7	0.2244	8.0	0.3150	12.0	0.4724
		+0.018	+0.0007	-0.017	-0.0007								
12.0	0.4724	+0.007	+0.0003	-0.006	-0.0002	20.0	0.7874	6.7	0.2638	10.0	0.3937	12.0	0.4724
		+0.018	+0.0007	-0.017	-0.0007								
16.0	0.6299	+0.007	+0.0003	-0.006	-0.0002	20.0	0.7874	8.7	0.3425	12.0	0.4724	12.0	0.4724
		+0.018	+0.0007	-0.017	-0.0007								
20.0	0.7874	+0.008	+0.0003	-0.007	-0.0003	20.0	0.7874	10.7	0.4213	14.0	0.5512	12.0	0.4724
		+0.021	+0.0008	-0.020	-0.0008								

MONTH INSERTS (without Arrow)

PART NUMBER	BODY DIA. "A"		PRICES
	mm	inches	
FA04	4.0	0.1575	\$62.70
FA05	5.0	0.1969	\$58.75
FA06	6.0	0.2362	\$85.80
FA08	8.0	0.3150	\$88.25
FA10	10.0	0.3937	\$90.55
FA12	12.0	0.4724	\$93.15
FA16	16.0	0.6299	\$95.65
FA20	20.0	0.7874	\$96.00

ARROWS (with or without Year)

PART NUMBER	ARROW DIA. "C"		PRICES
	mm	inches	
IA22XX*	2.2	0.0867	\$18.00
IA30XX*	3.0	0.1181	\$18.00
IA32XX*	3.2	0.1260	\$26.85
IA47XX*	4.7	0.1850	\$26.85
IA57XX*	5.7	0.2244	\$26.85
IA67XX*	6.7	0.2638	\$26.85
IA87XX*	8.7	0.3425	\$26.85
IA107XX*	10.7	0.4213	\$26.85

* Replace XX in part number with the last two digits of the year required, or use "SF" for arrow only.

31 DAY INSERTS (with Arrow)

PART NUMBER	BODY DIA. "A"		PRICES
	mm	inches	
FA06-31	6.0	0.2362	\$107.00
FA08-31	8.0	0.3150	\$109.00
FA10-31	10.0	0.3937	\$111.00
FA12-31	12.0	0.4724	\$114.00
FA16-31	16.0	0.6299	\$117.00
FA20-31	20.0	0.7874	\$133.00



PLASTIC PROCESS EQUIPMENT, INC.

6385 Montessouri Street, Las Vegas, Nevada 89113
702-433-6385 • 800-258-8877 • Fax: 702-433-6388

11218 Challenger Avenue, Odessa, Florida 33556
727-834-8888 • 800-282-6783 • Fax: 727-834-8873

8303 CORPORATE PARK DRIVE, MACEDONIA (Cleveland), OHIO 44056, USA

216-367-7000 • Toll Free: 800-321-0562 • Fax: 216-367-7022 • Order Fax: 800-223-8305

www.ppe.com • e-mail: sales@ppe.com

Toll Free: USA, Canada & Mexico
800-362-0706