



HEX SOCKET HEAD CAP SCREWS

KNURLED HEADS • HEAT-TREATED ALLOY STEEL

CLASS 3A THREADS



ISO-9000
MANUFACTURED IN A
QUALITY SYSTEM CERTIFIED
FACILITY.



TENSILE STRENGTH:
UP TO 1/2" DIA. 180,000 P.S.I.
5/8" OR LARGER 170,000 P.S.I.

DIA.	LENGTH (IN.)	COARSE THREADS			FINE THREADS			QTY PER BOX
		THD'S PER IN.	PPE PART NO.	PRICE EACH	THD'S PER IN.	PPE PART NO.	PRICE EACH	
1-1/2" (1.500") HEX KEY 1"	3"	6	SH112300C	\$27.05	-	-	-	BULK
	3-1/2"	6	SH112312C	\$29.88	-	-	-	BULK
	4"	6	SH112400C	\$32.29	-	-	-	BULK
	4-1/2"	6	SH112412C	\$34.55	-	-	-	BULK
	5"	6	SH112500C	\$35.68	-	-	-	BULK
	5-1/2"	6	SH112512C	\$39.34	-	-	-	BULK
	6"	6	SH112600C	\$41.78	-	-	-	BULK
	6-1/2"	6	SH112612C	\$42.23	-	-	-	BULK
	7"	6	SH112700C	\$44.80	-	-	-	BULK
	8"	6	SH112800C	\$52.97	-	-	-	BULK
	9"	6	SH112900C	\$57.48	-	-	-	BULK
	10"	6	SH1121000C	\$62.99	-	-	-	BULK
	12"	6	SH1121200C	\$77.41	-	-	-	BULK



HEX SOCKET HEAD STRIPPER BOLTS

CLASS FIT 3A - HARDNESS Rc 36-43

SHOULDER LENGTH	PRICING (EA. BOLT)					
	SHOULDER DIAMETER					
	1/4"	5/16"	3/8"	1/2"	5/8"	3/4"
3/8"	\$.78	\$.83	\$.81			
1/2"	\$.80	\$.85	\$.90	\$ 1.39		
5/8"	\$.83	\$.87	\$.99	\$ 1.67		
3/4"	\$.85	\$.95	\$ 1.07	\$ 1.71		
1"	\$.89	\$.98	\$ 1.12	\$ 1.84		
1-1/4"	\$.93	\$ 1.00	\$ 1.24	\$ 2.08	\$ 3.27	
1-1/2"	\$ 1.02	\$ 1.12	\$ 1.38	\$ 2.24	\$ 3.40	\$ 6.90
1-3/4"		\$ 1.19	\$ 1.49	\$ 2.45	\$ 3.98	\$ 7.49
2"		\$ 1.30	\$ 1.68	\$ 2.65	\$ 4.20	\$ 7.85
2-1/4"			\$ 1.88	\$ 2.85	\$ 4.83	\$ 8.37
2-1/2"			\$ 2.03	\$ 3.01	\$ 5.03	\$ 8.96
2-3/4"			\$ 2.30	\$ 3.71	\$ 5.43	\$ 9.53
3"			\$ 2.52	\$ 4.02	\$ 5.73	\$ 9.92
3-1/4"			\$ 2.91	\$ 4.45	\$ 6.37	\$ 10.80
3-1/2"			\$ 2.77	\$ 4.43	\$ 6.74	\$ 11.96
3-3/4"			\$ 3.11	\$ 4.73	\$ 7.32	\$ 12.59
4"			\$ 3.29	\$ 5.17	\$ 7.66	\$ 12.66
4-1/4"				\$ 5.79	\$ 8.02	\$ 13.57
4-1/2"				\$ 6.37	\$ 9.96	\$ 14.08
4-3/4"				\$ 6.87	\$ 11.04	\$ 15.08
5"				\$ 7.20	\$ 12.06	\$ 16.02
5-1/2"					\$ 13.24	\$ 17.48
6"					\$ 14.27	\$ 20.76

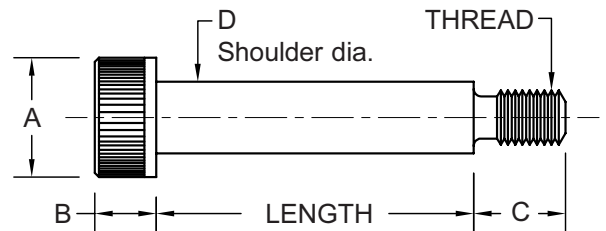

D SHOULDER DIA	THREAD	A (max)	B	C
1/4"	10-24	.375	.188	.375
5/16"	1/4-20	.438	.219	.438
3/8"	5/16-18	.562	.250	.500
1/2"	3/8-16	.750	.312	.625
5/8"	1/2-13	.875	.375	.750
3/4"	5/8-11	1.000	.500	.875

TO DETERMINE PART NUMBER:

SHSB + Shoulder Dia. + Length

Example: For a 3/8" dia. x 3-1/4" long bolt, the part number would be **SHSB38314**.

Prices are each bolt.

Box Quantities: 25 up to 5/8" x 3", 10 5/8" x 3-1/4" up to 3/4" x 6"



PLASTIC PROCESS EQUIPMENT, INC.

8303 CORPORATE PARK DRIVE
MACEDONIA, OHIO 44056-2300
216-367-7000 • FAX: 216-367-7022
TOLL FREE: 800-321-0562

6385 MONTESSOURI STREET
LAS VEGAS, NEVADA 89113-1186
702-433-6385 • FAX: 702-433-6388
TOLL FREE: 800-258-8877

www.ppe.com

e-mail: sales@ppe.com

Toll Free: USA, Canada & Mexico

800-362-0706

Order Fax: 800-223-8305