



# VACUUM CUPS



## Silicone Universal 1.5 Bellows Vacuum Cups – SBU-1



Silicone Material



SBU-1 Silicone 1.5 Bellows Vacuum Cups for handling sensitive or uneven products. FDA-Compliant silicone materials. Silicon rubber has a hardness of 50 - 65° Shore A. Connection via plug-in nipple.

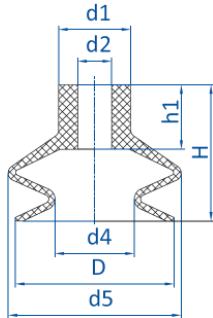

Drawing A

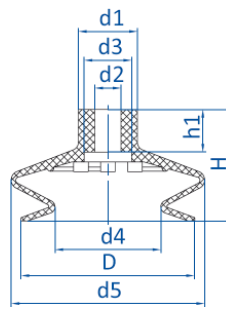

Drawing B

- Bellows compensate for differences in height and enables good adaptation to curved or uneven product surfaces.
- Soft attachment for sensitive products.
- Cost-effective replacement of worn seals.
- Color: Translucent

G1/8 Male Fitting  
Part No. **270-003**  
Price . . . **\$2.90 ea.**

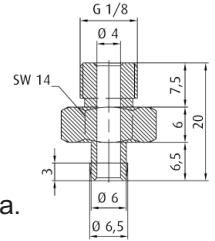

G1/8 Male Fitting  
Part No. **270-196**  
Price . . . **\$3.18 ea.**

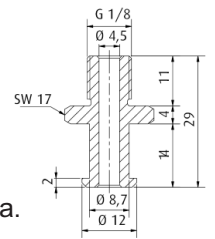

Part No.	Drawing	D	D1	D2	D3	D4	D5	H	H1	Fitting	Price
23-011-008-2	A	12mm	10mm	5mm	--	4.5mm	12mm	16mm	9mm	270-003	\$2.96
23-016-016-2	A	16mm	10mm	5mm	--	8mm	17mm	19mm	9mm	270-003	\$2.96
23-022-028-2	A	22mm	10mm	4.5mm	--	11mm	24mm	19mm	9mm	270-003	\$6.24
23-033-039-2	B	33.5mm	18mm	8mm	16.5mm	17mm	36mm	28mm	13mm	270-196	\$6.46
23-043-096-2	B	43mm	18mm	8mm	14.5mm	23mm	45mm	27mm	12mm	270-196	\$8.22

## Silicone Universal 2.5 Bellows Vacuum Cups – SBU-2



Silicone Material



SBU-2 Silicone 2.5 Bellows Vacuum Cups for handling sensitive or uneven products over large stroke movements. FDA-Compliant silicone materials. Silicon rubber has a hardness of 50 - 65° Shore A. Connection via plug-in nipple.

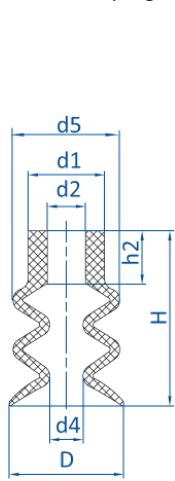

Drawing A

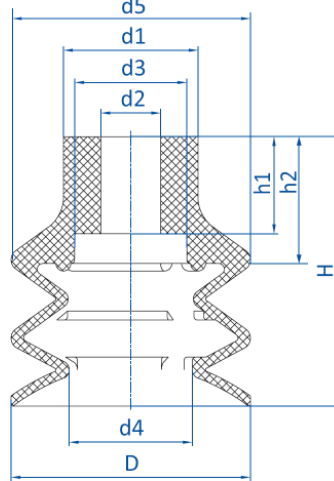

Drawing B

- Bellows compensate for differences in height and enables good adaptation to curved or uneven product surfaces.
- Soft attachment for sensitive products.
- Cost-effective replacement of worn seals.
- Color: Translucent

G1/8 Male Fitting  
Part No. **270-003**  
Price . . . **\$2.90 ea.**

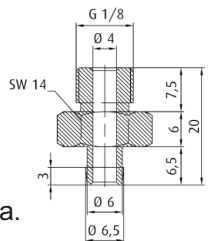

G1/8 Male Fitting  
Part No. **270-196**  
Price . . . **\$3.18 ea.**

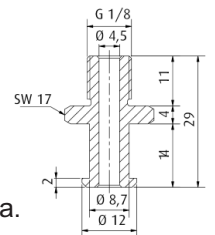

Part No.	Drawing	D	D1	D2	D3	D4	D5	H	H1	H2	Fitting	Price
21-010-119-2	A	10mm	10mm	5mm	--	4.5mm	10mm	21mm	--	7mm	270-003	\$4.85
21-012-135-2	A	12mm	10mm	5mm	--	5mm	12mm	21mm	--	9mm	270-003	\$4.75
21-014-007-2	A	15mm	10mm	5mm	--	4.5mm	15mm	23mm	--	7mm	270-003	\$4.96
21-020-016-2	A	20mm	10mm	4.5mm	--	10mm	20mm	23mm	--	9mm	270-003	\$5.05
21-032-075-2	B	32mm	18mm	8mm	15mm	16.5mm	32mm	36mm	13mm	17mm	270-196	\$6.39
21-043-049-2	B	42mm	20mm	8mm	15mm	15.5mm	42mm	46mm	13mm	17mm	270-196	\$8.26



### PLASTIC PROCESS EQUIPMENT, INC.

6385 Montessouri Street, Las Vegas, Nevada 89113  
702-433-6385 • 800-258-8877 • Fax: 702-433-6388

11218 Challenger Avenue, Odessa, Florida 33556  
727-834-8888 • 800-282-6783 • Fax: 727-834-8873

8303 CORPORATE PARK DRIVE, MACEDONIA (Cleveland), OHIO 44056, USA

216-367-7000 • Toll Free: 800-321-0562 • Fax: 216-367-7022 • Order Fax: 800-223-8305

www.ppe.com • e-mail: sales@ppe.com

Toll Free: USA, Canada & Mexico  
**800-362-0706**