

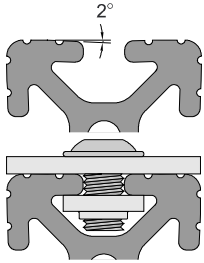

# ALUMINUM 80/20 PROFILES

## FOR BUILDING EOAT FRAMES



EXTRUDED ALUMINUM PROFILES are ideal for building custom robot end of arm tooling frames. The lightweight anodized aluminum extrusions are available in a variety of different sizes and shapes.

**Vibration Proof design**, all T-slotted structural extrusions have a drop lock feature - a 2° decline on the T-slot flange. This drop lock acts as a lockwasher in that it spring loads the fastener as it's tightened.

The extrusions are 6105-T5 aluminum, Etch and Clear Anodize #204-R1 with a depth of .0004". Yield strength 35,000 lbs/sq in, tensile strength 38,000 lbs/sq in, conforms to Din 17 615 specifications.

### 10 SERIES 80/20 PROFILES

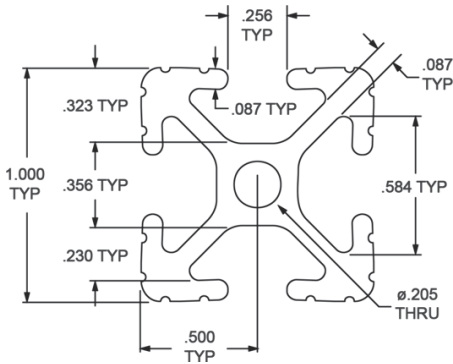

**10 SERIES**  
**4 OPEN T-SLOTS**  
 1" x 1" x 48"  
 .508 lbs/ft  
 Part No. **EXT1010**  
 Price . . . **\$11.89**

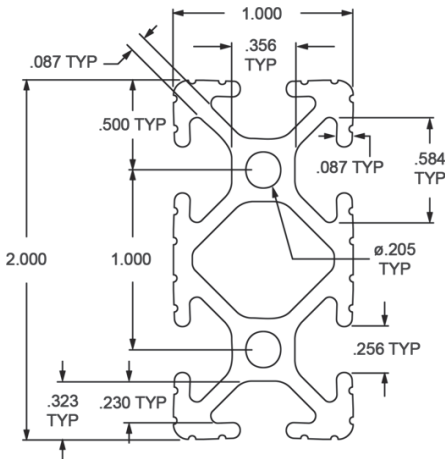

**10 SERIES**  
**6 OPEN T-SLOTS**  
 1" x 2" x 48"  
 .920 lbs/ft  
 Part No. **EXT1020**  
 Price . . . **\$20.31**

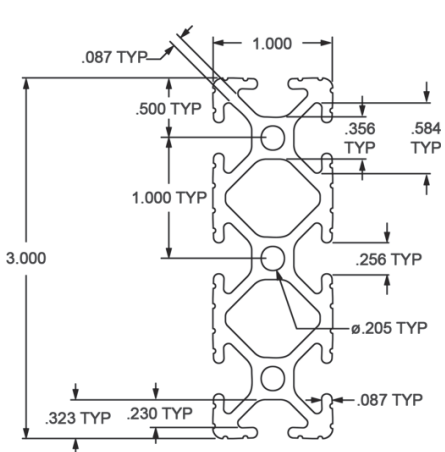

**10 SERIES**  
**8 OPEN T-SLOTS**  
 1" x 3" x 48"  
 1.348 lbs/ft  
 Part No. **EXT1030**  
 Price . . . **\$29.08**

### 10 SERIES ACCESSORIES

#### SAE T-NUTS

Economy T-Nut - Zinc Plated  
 .443W x 1.000L x .094T w/ 1/4-20 Thd  
 Part No. **EXT3785** . . . . . \$ .28 ea.

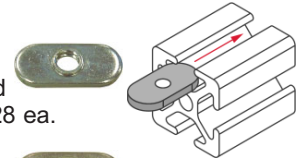

Economy T-Nut - Unplated  
 .443W x 1.000L x .094T w/ 1/4-20 Thd  
 Part No. **ND2116** . . . . . \$ .13 ea.

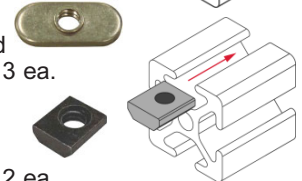

T-Nut - Black Zinc  
 .431W x .490L x .171T w/ 1/4-20 Thd  
 Part No. **3204** . . . . . \$1.12 ea.



#### METRIC T-NUTS

Metric Economy T-Nut - Unplated  
 .433W x .866L x .094T w/ M5 Thd  
 Part No. **NDM05022** . . . . . \$ .27 ea.

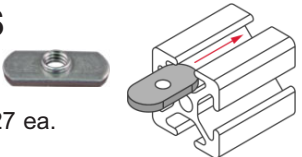

Metric T-Nut - Black Zinc  
 .431W x .490L x .171T w/ M5 Thd  
 Part No. **3206** . . . . . \$1.23 ea.

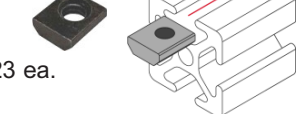

#### CAP SCREWS

THREAD SIZE	TYPE	LENGTH	PART NO.	PRICE EACH
SAE 1/4-20	BUTTON HEAD	3/8"	BH014038C	\$ .05
		1/2"	BH014012C	\$ .06
		5/8"	BH014058C	\$ .09
		3/4"	BH014034C	\$ .10
	SOCKET HEAD	3/8"	SH014038C	\$ .04
		1/2"	SH014012C	\$ .029
		5/8"	SH014058C	\$ .033
		3/4"	SH014034C	\$ .034
		7/8"	SH014078C	\$ .038
		1"	SH014100C	\$ .04
METRIC M5x0.8mm	BUTTON HEAD	10	BH05010M	\$ .06
		12	BH05012M	\$ .10
		16	BH05016M	\$ .11
	SOCKET HEAD	10	SH0510M	\$ .07
		12	SH0512M	\$ .07
		16	SH0516M	\$ .07
		20	SH0520M	\$ .08
		25	SH0525M	\$ .08



## PLASTIC PROCESS EQUIPMENT, INC.

www.ppe.com • e-mail: sales@ppe.com

**PPE WEST** 6385 Montessouri Street, Las Vegas, Nevada 89113  
 702-433-6385 • 800-258-8877 • Fax: 702-433-6388

**PPE SOUTH** 11218 Challenger Avenue, Odessa, Florida 33556  
 727-834-8888 • 800-282-6783 • Fax: 727-834-8873

8303 CORPORATE PARK DRIVE, MACEDONIA (Cleveland), OHIO 44056, USA

Toll Free: USA, Canada & Mexico  
**800-362-0706**

216-367-7000 • Toll Free: 800-321-0562 • Fax: 216-367-7022 • Order Fax: 800-223-8305