



DOUBLE VALVES FOR PART EJECTION

ISO-9001
MANUFACTURED IN A
QUALITY SYSTEM CERTIFIED
FACILITY.

FEATURES

- Eliminate ejection problems with deep molded parts that commonly create gas traps or vacuum conditions.
- Allows air to pass through gap when pressure is applied.
- Precision tolerance of 0.0012" prevents plastic from entering gap during injection.
- Also acts as a vent to relieve gas pressure.
- Made from AISI 420 stainless, 50-55 Rc.
- 4 diameters available.

CUMSA system



VALVE DIMENSIONS

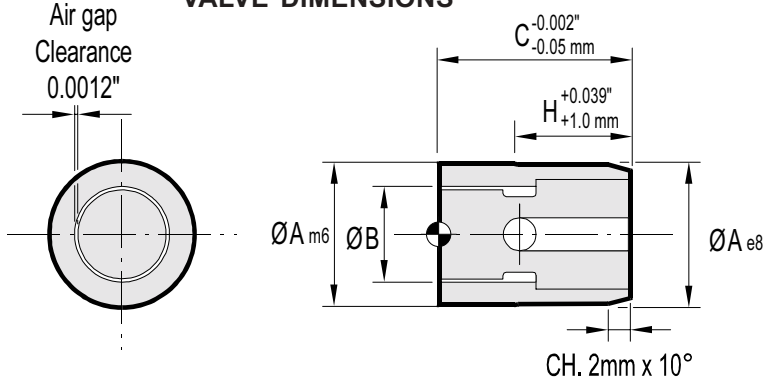

HOLE DIMENSIONS & INSTALLATION

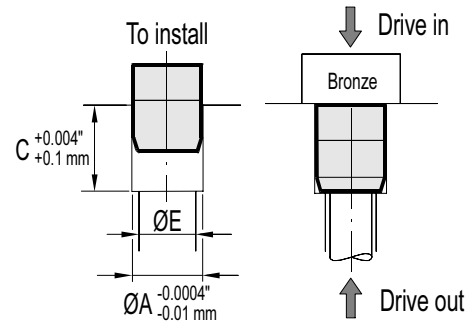

Drill a hole per the specifications listed. Insert has an undersized portion to allow partial entry into the drilled hole. Use a bronze block against the insert face and drive down into position. To remove, drive out from the rear.

DIMENSIONS & TOLERANCES

| ØA BODY DIAMETER | | m6 TOLERANCE | | e8 TOLERANCE | | ØB | | C | | ØE | | H | |
|------------------|--------|--------------|---------|--------------|---------|------|--------|------|--------|-----|--------|------|--------|
| mm | inches | mm | inches | mm | inches | mm | inches | mm | inches | mm | inches | mm | inches |
| 8.0 | 0.3150 | +0.006 | +0.0002 | -0.025 | -0.0009 | 5.0 | 0.1969 | 12.0 | 0.4724 | 4.0 | 0.1575 | 7.0 | 0.2756 |
| | | +0.015 | +0.0006 | -0.047 | -0.0017 | | | | | | | | |
| 10.0 | 0.3937 | +0.007 | +0.0003 | -0.032 | -0.0013 | 6.0 | 0.2362 | 12.0 | 0.4724 | 5.0 | 0.1969 | 7.0 | 0.2756 |
| | | +0.018 | +0.0007 | -0.059 | -0.0023 | | | | | | | | |
| 12.0 | 0.4724 | +0.007 | +0.0003 | -0.032 | -0.0013 | 8.0 | 0.3150 | 12.0 | 0.4724 | 7.0 | 0.2756 | 7.0 | 0.2756 |
| | | +0.018 | +0.0007 | -0.059 | -0.0023 | | | | | | | | |
| 16.0 | 0.6299 | +0.007 | +0.0003 | -0.032 | -0.0013 | 10.0 | 0.3937 | 20.0 | 0.7874 | 9.0 | 0.3543 | 12.0 | 0.4724 |
| | | +0.018 | +0.0007 | -0.059 | -0.0023 | | | | | | | | |

TYPICAL APPLICATION

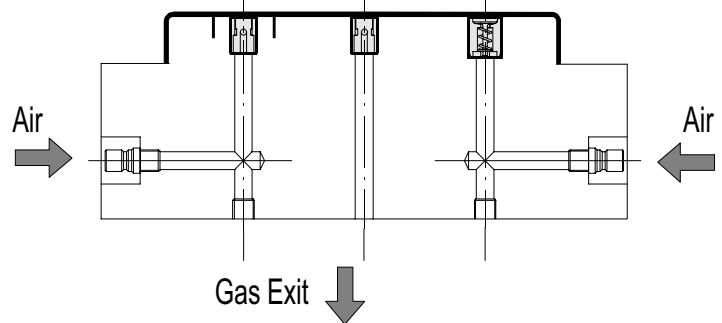

| PART NUMBER | BODY DIAMETER A | | PRICE |
|-------------|-----------------|--------|---------|
| | mm | inches | |
| VD08 | 8.0 | 0.3150 | \$44.00 |
| VD10 | 10.0 | 0.3937 | \$45.00 |
| VD12 | 12.0 | 0.4724 | \$46.00 |
| VD16 | 16.0 | 0.6299 | \$47.00 |



PLASTIC PROCESS EQUIPMENT, INC.

www.ppe.com • e-mail: sales@ppe.com

6385 Montessouri Street, Las Vegas, Nevada 89113
PPE WEST 702-433-6385 • 800-258-8877 • Fax: 702-433-6388

11218 Challenger Avenue, Odessa, Florida 33556
PPE SOUTH 727-834-8888 • 800-282-6783 • Fax: 727-834-8873

8303 CORPORATE PARK DRIVE, MACEDONIA (Cleveland), OHIO 44056, USA

Toll Free: USA, Canada & Mexico

216-367-7000 • Toll Free: 800-321-0562 • Fax: 216-367-7022 • Order Fax: 800-223-8305

800-362-0706