



ISO-9000
 MANUFACTURED IN A
 QUALITY SYSTEM CERTIFIED
 FACILITY.

HEX SOCKET HEAD CAP SCREWS

KNURLED HEADS • HEAT-TREATED ALLOY STEEL

CLASS 3A THREADS



TENSILE STRENGTH:
 UP TO 1/2" DIA. 180,000 P.S.I.
 5/8" OR LARGER 170,000 P.S.I.

**SOLD IN
 BOX QUANTITIES**

DIA.	LENGTH (IN.)	COARSE THREADS			FINE THREADS			QTY PER BOX
		THD'S PER IN.	PPE PART NUMBER	PRICE EACH	THD'S PER IN.	PPE PART NUMBER	PRICE EACH	
1-1/2" (1.500") HEX KEY 1"	3"	6	SH112300C	\$8.65	-	-	-	BULK
	3-1/2"	6	SH112312C	9.03	-	-	-	BULK
	4"	6	SH112400C	9.42	-	-	-	BULK
	4-1/2"	6	SH112412C	10.30	-	-	-	BULK
	5"	6	SH112500C	10.89	-	-	-	BULK
	5-1/2"	6	SH112512C	11.58	-	-	-	BULK
	6"	6	SH112600C	12.14	-	-	-	BULK
	6-1/2"	6	SH112612C	12.85	-	-	-	BULK
	7"	6	SH112700C	14.11	-	-	-	BULK
	8"	6	SH112800C	15.78	-	-	-	BULK
	9"	6	SH112900C	17.63	-	-	-	BULK
	10"	6	SH1121000C	19.19	-	-	-	BULK
12"	6	SH1121200C	23.09	-	-	-	BULK	

**NEW
 LOWER
 PRICES**



HEX SOCKET HEAD STRIPPER BOLTS

CLASS FIT 3A - HARDNESS Rc 36-43

SHOULDER LENGTH	PRICING (EA. BOLT)					
	SHOULDER DIAMETER					
	1/4"	5/16"	3/8"	1/2"	5/8"	3/4"
3/8"	\$0.38	\$0.42	\$0.49			
1/2"	0.39	0.43	0.50	\$0.94		
5/8"	0.39	0.44	0.50	0.97		
3/4"	0.40	0.45	0.51	0.99		
1"	0.42	0.44	0.54	1.01		
1-1/4"	0.47	0.47	0.56	1.04	\$1.70	
1-1/2"	0.50	0.51	0.59	1.09	1.75	\$2.85
1-3/4"		0.53	0.62	1.13	1.83	2.93
2"		0.56	0.67	1.14	1.86	3.04
2-1/4"			0.71	1.29	2.07	3.16
2-1/2"			0.82	1.35	2.17	3.30
2-3/4"			0.92	1.46	2.39	3.62
3"			1.06	1.48	2.51	3.77
3-1/4"			1.11	1.66	2.76	4.17
3-1/2"			1.32	1.76	2.98	4.34
3-3/4"			1.38	1.79	3.27	4.94
4"			1.52	2.13	3.40	4.99
4-1/4"				2.42	3.77	5.41
4-1/2"				2.66	3.82	5.48
4-3/4"				2.83	4.35	6.07
5"				3.07	4.38	6.14
5-1/2"					5.01	8.42
6"					5.57	9.34

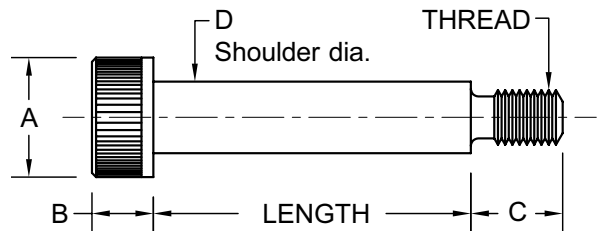

D SHOULDER DIA	THREAD	A (max)	B	C
1/4"	10-24	.375	.188	.375
5/16"	1/4-20	.438	.219	.438
3/8"	5/16-18	.562	.250	.500
1/2"	3/8-16	.750	.312	.625
5/8"	1/2-13	.875	.375	.750
3/4"	5/8-11	1.000	.500	.875

TO DETERMINE PART NUMBER:

SHSB + Shoulder Dia. + Length

Example: For a 3/8" dia. x 3-1/4" long bolt, the part number would be **SHSB38314**.

Prices are each bolt.

Box Quantities: 25 up to 5/8" x 3", 10 5/8" x 3-1/4" up to 3/4" x 6"



PLASTIC PROCESS EQUIPMENT, INC.

8303 CORPORATE PARK DRIVE, MACEDONIA (Cleveland), OHIO 44056, USA
 216-367-7000 • Toll Free: 800-321-0562 • Fax: 216-367-7022 • Order Fax: 800-223-8305

www.ppe.com • e-mail: sales@ppe.com

Toll Free: USA, Canada & Mexico
800-362-0706

PPE WEST 3615 Walnut Avenue, Chino, California 91710, USA
 909-627-8511 • 800-258-8877 • Fax: 909-627-8101

PPE SOUTH 11218 Challenger Avenue, Odessa, Florida 33556, USA
 727-834-8888 • 800-282-6783 • Fax: 727-834-8873