

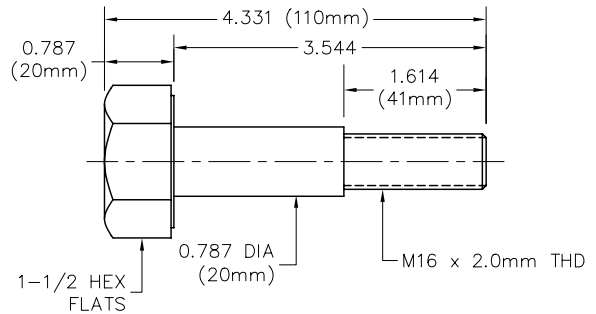

HEAVY DUTY HEX HEAD BOLTS

OVERSIZE HEX HEAD - METRIC SIZES

M16 X 2.0MM

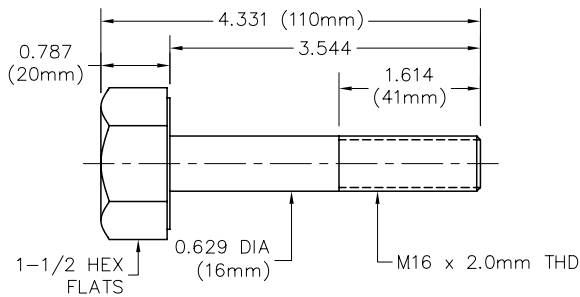

PART NO. M1658S

1 - 8 pcs	\$10.50 ea
9 - 23	\$10.00 ea
24 & over	\$9.50 ea

PART NO. M1634S

1 - 8 pcs	\$10.50 ea
9 - 23	\$10.00 ea
24 & over	\$9.50 ea

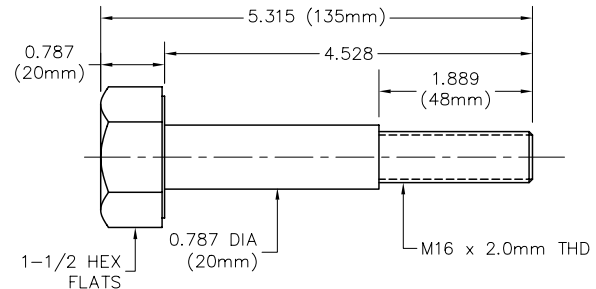
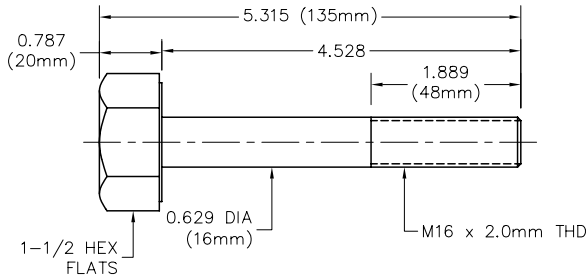

PART NO. M1658L

1 - 8 pcs	\$11.25 ea
9 - 23	\$10.75 ea
24 & over	\$10.00 ea

PART NO. M1634L

1 - 8 pcs	\$11.25 ea
9 - 23	\$10.75 ea
24 & over	\$10.00 ea

M20 X 2.5MM

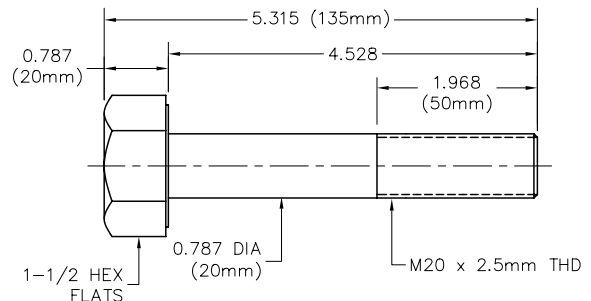
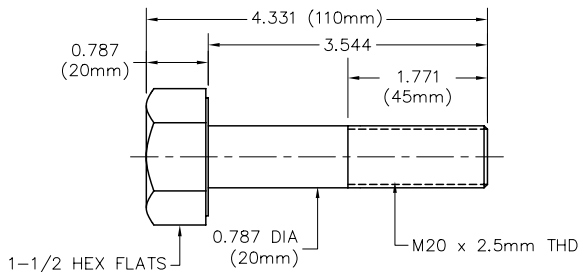

PART NO. M2034S

1 - 8 pcs	\$10.60 ea
9 - 23	\$10.10 ea
24 & over	\$9.50 ea

PART NO. M2034L

1 - 8 pcs	\$11.75 ea
9 - 23	\$11.25 ea
24 & over	\$10.75 ea



PLASTIC PROCESS EQUIPMENT, INC.

8303 CORPORATE PARK DRIVE, MACEDONIA (Cleveland), OHIO 44056, USA
216-367-7000 • Toll Free: 800-321-0562 • Fax: 216-367-7022 • Order Fax: 800-223-8305

www.ppe.com • e-mail: sales@ppe.com

Toll Free: USA, Canada & Mexico

800-362-0706

PPE WEST 3615 Walnut Avenue, Chino, California 91710, USA
909-627-8511 • 800-258-8877 • Fax: 909-627-8101

PPE SOUTH 11218 Challenger Avenue, Odessa, Florida 33556, USA
727-834-8888 • 800-282-6783 • Fax: 727-834-8873