

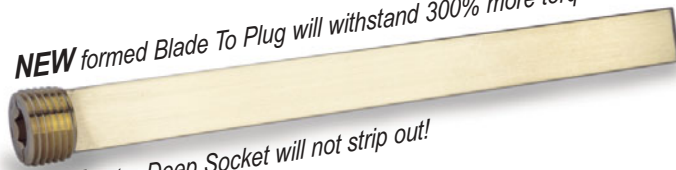

Straight Brass Plug Baffles

NEW formed Blade To Plug will withstand 300% more torque!



NEW Extra Deep Socket will not strip out!

- Flush-seal type (7/8 taper) brass pipe plugs standard. Alloy, stainless, and oversize (3/4 taper) plugs available.
- Precision soldered to exacting tolerances to closely fit the cooling channel.
- Custom stepped width blades, and plug size combinations quoted on request.
- 3/4" NPT Brass Plug Baffles for use with 29/32" tap drill are available from stock.

NEW !!
Longer lengths !!

Part Number	Plug Size (NPT)	Overall Length	Blade Width (-.005) (-.015)	Drill Dia.	Blade Thk.	Price
SB16X4	1/16"	4"	1/4"	1/4"	.050	\$2.80
SB16X8	1/16"	8"	1/4"	1/4"	.050	3.05
SB16X12	1/16"	12"	1/4"	1/4"	.050	3.60
SB18X4	1/8"	4"	5/16"	5/16"	.050	2.30
SB18X8	1/8"	8"	5/16"	5/16"	.050	2.55
SB18X12	1/8"	12"	5/16"	5/16"	.050	2.90
SB14X5	1/4"	5"	7/16"	7/16"	.080	2.95
SB14X10	1/4"	10"	7/16"	7/16"	.080	3.35
SB14X15	1/4"	15"	7/16"	7/16"	.080	4.10
SB38X6	3/8"	6"	9/16"	9/16"	.090	3.95
SB38X12	3/8"	12"	9/16"	9/16"	.090	4.45
SB38X18	3/8"	18"	9/16"	9/16"	.090	5.15
SB12X8	1/2"	8"	11/16"	11/16"	.090	4.45
SB12X16	1/2"	16"	11/16"	11/16"	.090	5.15
SB34X12	3/4"	12"	15/16"	15/16"	.090	6.80
SB34X20	3/4"	20"	15/16"	15/16"	.090	8.10
SB1X16	1"	16"	1-1/8"	1-1/8"	.105	12.45
SB1X24	1"	24"	1-1/8"	1-1/8"	.105	14.85

Turbo Blade Plug Baffles

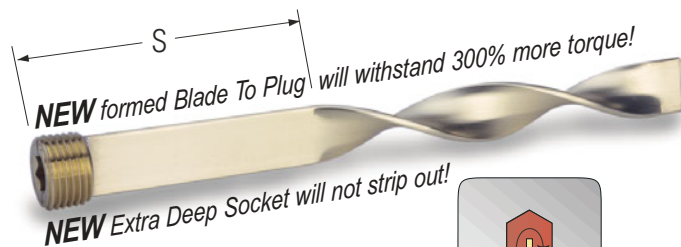

NEW formed Blade To Plug will withstand 300% more torque!

NEW Extra Deep Socket will not strip out!

- Spiral provides turbulent cooling action and keeps blade centered in waterline for maximum flow rates.

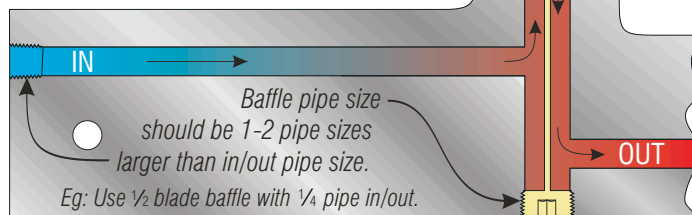

Part Number	Plug Size (NPT)	Overall Length	Straight Length "S"	Blade Width (-.005) (-.015)	Drill Dia.	Blade Thk.	Price
TB16X4	1/16"	4"	2"	1/4"	1/4"	.050	\$3.55
TB16X8	1/16"	8"	4"	1/4"	1/4"	.050	3.80
TB16X12	1/16"	12"	6"	1/4"	1/4"	.050	4.35
TB18X4	1/8"	4"	2"	5/16"	5/16"	.050	3.05
TB18X8	1/8"	8"	4"	5/16"	5/16"	.050	3.30
TB18X12	1/8"	12"	6"	5/16"	5/16"	.050	3.70
TB14X5	1/4"	5"	2"	7/16"	7/16"	.080	3.75
TB14X10	1/4"	10"	4"	7/16"	7/16"	.080	4.10
TB14X15	1/4"	15"	6"	7/16"	7/16"	.080	4.85
TB38X6	3/8"	6"	2"	9/16"	9/16"	.090	4.85
TB38X12	3/8"	12"	4"	9/16"	9/16"	.090	5.35
TB38X18	3/8"	18"	6"	9/16"	9/16"	.090	6.10
TB12X8	1/2"	8"	3"	11/16"	11/16"	.090	5.35
TB12X16	1/2"	16"	5"	11/16"	11/16"	.090	6.10
TB34X12	3/4"	12"	4"	15/16"	15/16"	.090	8.00
TB34X20	3/4"	20"	6"	15/16"	15/16"	.090	9.35
TB1X16	1"	16"	5"	1-1/8"	1-1/8"	.105	13.80
TB1X24	1"	24"	8"	1-1/8"	1-1/8"	.105	17.35

Blade Material Only

NEW!



- Held to exact tolerances to closely fit cooling channel diameters.
- Longer lengths available.

Part Number	Plug Size (NPT)	Overall Length (In.)	Blade Width (-.005) (-.015)	Blade Thk.	Price
BM16	1/16"	36"	1/4"	.050	\$5.95
BM18	1/8"	36"	5/16"	.050	6.10
BM14	1/4"	36"	7/16"	.080	6.55
BM38	3/8"	36"	9/16"	.090	7.10
BM12	1/2"	36"	11/16"	.090	8.65
BM34	3/4"	36"	15/16"	.090	10.40
BM34-9	3/4"	36"	29/32"	.090	11.40
BM1	1"	36"	1-1/8"	.105	14.70



PLASTIC PROCESS EQUIPMENT, INC.

8303 CORPORATE PARK DRIVE, MACEDONIA (Cleveland), OHIO 44056, USA
216-367-7000 • Toll Free: 800-321-0562 • Fax: 216-367-7022 • Order Fax: 800-223-8305

www.ppe.com • e-mail: sales@ppe.com

Toll Free: USA, Canada & Mexico

800-362-0706

PPE WEST 3615 Walnut Avenue, Chino, California 91710, USA
909-627-8511 • 800-258-8877 • Fax: 909-627-8101

PPE SOUTH 11218 Challenger Avenue, Odessa, Florida 33556, USA
727-834-8888 • 800-282-6783 • Fax: 727-834-8873